

# WEST DESERT AIRPARK

## FAIRFIELD, UTAH

### CONSTRUCTION DRAWINGS

ACI No. 206685

PREPARED BY:  
**ARMSTRONG CONSULTANTS, INC.**  
 NOVEMBER 2021

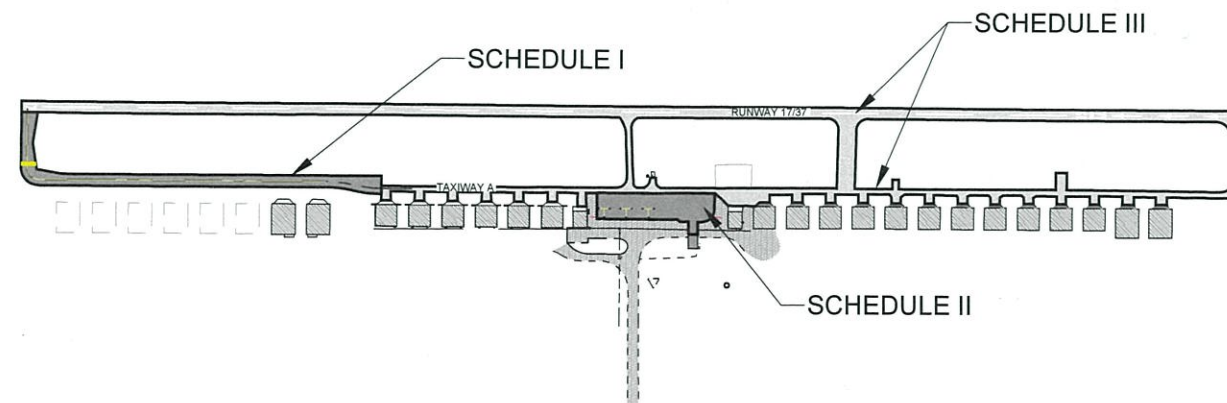
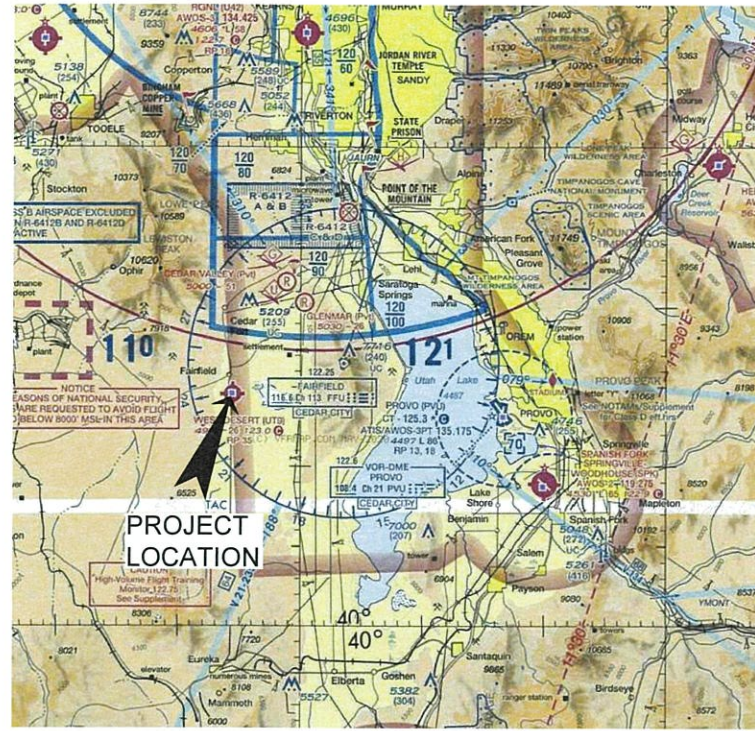

*Thorsen Milton* 2/15/2022  
 DESIGNED BY: DATE

REVIEWED BY AND PREPARED UNDER MY DIRECT SUPERVISION:



REGISTERED PROFESSIONAL ENGINEER DATE

#### INDEX TO SHEETS

COVER SHEET	1.1
GENERAL NOTES, LEGEND & SURVEY CONTROL	1.2
DEMOLITION PLAN	2.1 - 2.3
TAXIWAY A PLAN AND PROFILE	3.1 - 3.2
APRON PLAN AND PROFILE	4.1
DETAILS	5.1
MARKING PLAN	6.1 - 6.5
DETAILS	6.6
RETROREFLECTIVE TAXIWAY EDGE MARKER LAYOUT	7.4
TAXIWAY SECTIONS	8.1 - 8.3
APRON SECTIONS	8.4
CONSTRUCTION SAFETY & PHASING PLAN	ATTACHED SHEET 1.1

- SCHEDULE I  
 CONSTRUCT TAXIWAY A  
 (DESIGN ONLY)
- SCHEDULE II  
 CONSTRUCT APRON  
 (DESIGN ONLY)
- SCHEDULE III  
 RUNWAY AND TAXIWAY  
 PAVEMENT MARKINGS  
 AND REPAIR /FOGSEAL  
 (DESIGN ONLY)



S:\Utah\West Desert Airport\Project Files\Active Projects\206685 - West Desert - Taxiway Extension\CAD\dwg\206685101.dwg 12/17/2021 11:58:35 AM MMONROE

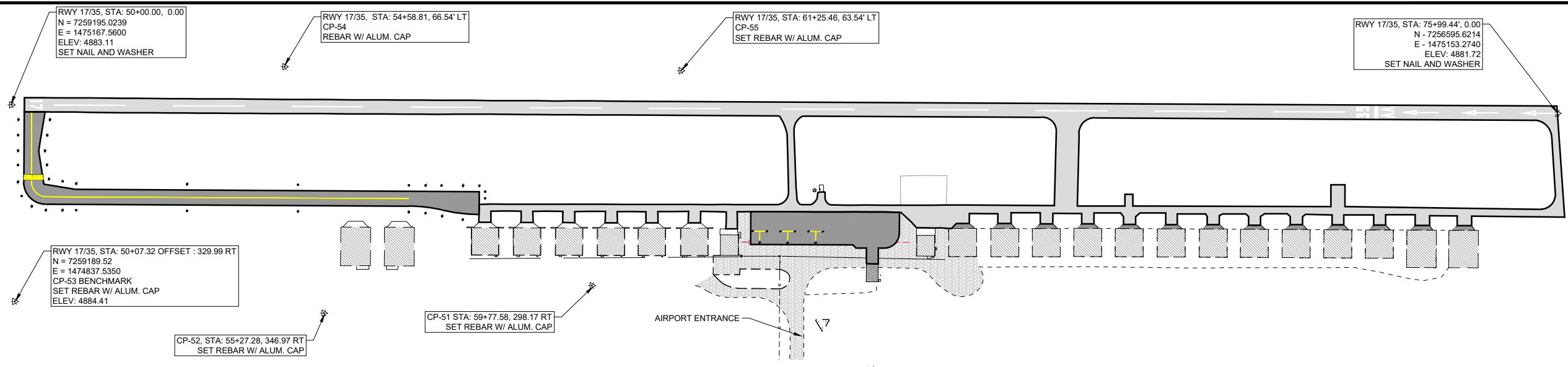

**LEGEND**

Symbol	Description	Symbol	Description
x 0.00	EXISTING SPOT ELEVATION	x 99.99	PROPOSED FINISHED GRADE ELEVATION
- - - - -	EXISTING GROUND CONTOUR (5' INTERVAL)	- - - - -	PROPOSED GROUND CONTOUR (1' INTERVAL)
⊗	EXISTING RUNWAY EDGE LIGHT	⊗	PROPOSED RUNWAY EDGE LIGHT
⊙	EXISTING TAXIWAY EDGE LIGHT	⊙	PROPOSED TAXIWAY EDGE LIGHT
◇	EXISTING RETROREFLECTIVE MARKER	◇	PROPOSED TAXIWAY RETROREFLECTIVE MARKER
□	EXISTING SPLICE BASE	□	PROPOSED SPLICE BASE / PULL BOX
⊠	EXISTING AIRFIELD SIGN	⊠	PROPOSED AIRFIELD SIGN
⊡	EXISTING BEACON	⊡	PROPOSED BEACON AND TOWER
⊢	EXISTING WIND CONE	⊢	PROPOSED LIGHTED WIND CONE
⊣	EXISTING SEGMENTED CIRCLE	⊣	PROPOSED SEGMENTED CIRCLE
⊤	EXISTING PAPI / VASI	⊤	PROPOSED PAPI
⊥	EXISTING REIL	⊥	PROPOSED REIL
⊦	EXISTING AWOS/ASOS/UNICOM	⊦	PROPOSED AWOS
⊧	EXISTING TIEDOWN ANCHOR	⊧	PROPOSED TIEDOWN ANCHOR
⊨	EXISTING UTILITY POLE	⊨	PROPOSED UTILITY POLE
⊩	EXISTING AREA LIGHT	⊩	PROPOSED SUPPLEMENTAL WIND CONE
⊪	EXISTING GUY	⊪	PROPOSED AREA LIGHT (S)
⊫	EXISTING PAD MOUNTED TRANSFORMER	⊫	PROPOSED ELECTRIC TRANSFORMER
⊬	EXISTING FIRE HYDRANT	⊬	PROPOSED FIRE HYDRANT
⊭	EXISTING WATER VALVE	⊭	PROPOSED WATER VALVE
⊮	EXISTING AREA INLET	⊮	PROPOSED STORM DRAIN INLET
⊯	EXISTING MANHOLE / CLEAN-OUT	⊯	PROPOSED MANHOLE
⊰	EXISTING TELEPHONE RISER	⊰	PROPOSED SURVEY MONUMENT
⊱	EXISTING ROAD SIGN(S)	⊱	PROPOSED AIRFIELD POWER CABLE(S)
⊲	EXISTING SECTION CORNER	⊲	PROPOSED COUNTERPOISE CABLE
⊳	EXISTING SURVEY CONTROL MONUMENT	⊳	PROPOSED CONCRETE ENCASED DUCT BANK
⊴	EXISTING PROPERTY CORNER PIN/CAP	⊴	PROPOSED CULVERT w/END SECTIONS
⊵	EXISTING AIRFIELD POWER CABLE(S)	⊵	PROPOSED SWALE DIRECTION
⊶	EXISTING DUCT	⊶	PROPOSED BARBED WIRE FENCE
⊷	EXISTING CULVERT	⊷	PROPOSED CHAIN LINK FENCE
⊸	EXISTING SWALE DIRECTION	⊸	PROPOSED WILDLIFE FENCE
⊹	EXISTING BARB WIRE FENCE	⊹	PROPOSED SANITARY SEWER LINE
⊺	EXISTING CHAIN LINK FENCE	⊺	PROPOSED STORM DRAIN LINE
⊻	EXISTING WILDLIFE FENCE	⊻	PROPOSED WATERLINE
⊼	EXISTING SANITARY SEWER LINE	⊼	PROPOSED GAS LINE
⊽	EXISTING STORM DRAIN LINE	⊽	PROPOSED UNDERGROUND POWER/TELE
⊾	EXISTING WATER LINE	⊾	PROPOSED PERFORATED UNDERDRAIN W/ CLEAN-OUT
⊿	EXISTING GAS LINE	⊿	PROPOSED NON-PERFORATED UNDERDRAIN
Ⓚ	EXISTING UNDERGROUND POWER OR TELE. LINE	Ⓚ	PROPOSED SEDIMENT LOG
Ⓛ	EXISTING OVERHEAD POWER CABLE	Ⓛ	PROPOSED SILT FENCE
Ⓜ	EXISTING UNDERGROUND COMMUNICATION LINE	Ⓜ	PROPOSED CONCRETE PAVEMENT
Ⓨ	EXISTING FIBER OPTIC CABLE	Ⓨ	PROPOSED ASPHALT PAVEMENT
Ⓩ	EXISTING UNDERDRAIN W/ CLEAN-OUT	Ⓩ	PROPOSED ASPHALT PAVEMENT OVERLAY
ⓐ	EXISTING ASPHALT PAVEMENT EDGE	ⓐ	PROPOSED MARKING REMOVAL
ⓑ	EXISTING CONCRETE PAVEMENT EDGE	ⓑ	PROPOSED GRAVEL
ⓓ	EXISTING GRAVEL EDGE	ⓓ	PROPOSED ASPHALT AND GRAVEL REMOVAL
ⓔ	EXISTING CONCRETE PAVEMENT	ⓔ	PROPOSED BUILDING
ⓕ	EXISTING ASPHALT PAVEMENT	ⓕ	PROPOSED SEEDING AREA
ⓖ	EXISTING GRAVEL	ⓖ	PROPOSED GRADING AREA
ⓗ	EXISTING BUILDING		
ⓘ	EXISTING WETLANDS		

NOTE: LEGEND APPLIES TO ALL SHEETS IN THIS PLAN SET, IS GENERIC, AND NOT ALL SYMBOLS MAY BE IN PLAN SHEETS.

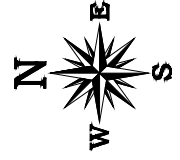

**SURVEY CONTROL**



**GENERAL NOTES**

- ESTIMATED QUANTITIES ARE CONSIDERED APPROXIMATE ONLY EXCEPT WHERE PLAN QUANTITIES ARE SPECIFIED FOR PAYMENT. ACTUAL QUANTITIES SHALL BE DETERMINED BY FIELD MEASUREMENT OR SPECIFICATIONS.
- THE CONTRACTOR SHALL PROVIDE MATERIAL SUBMITTALS FOR THE ENGINEER'S APPROVAL PRIOR TO ORDERING.
- THE CONTRACTOR IS REQUIRED TO OBTAIN ALL NECESSARY CONSTRUCTION PERMITS AS NECESSARY FOR THE PROJECT.
- THE CONTRACTOR SHALL BE REQUIRED TO SUBMIT A WORK SCHEDULE AND PROPOSED CONSTRUCTION METHODS AT THE PRE-CONSTRUCTION CONFERENCE.
- THE CONTRACTOR SHALL OBTAIN APPROVAL FROM AIRPORT MANAGEMENT AND THE ENGINEER PRIOR TO ESTABLISHING CONSTRUCTION ACCESS OR HAUL ROADS. EXISTING PAVEMENT SURFACES OTHER THAN AIRFIELD PAVEMENTS SHALL BE USED TO THE MAXIMUM EXTENT POSSIBLE.
- THE CONTRACTOR SHALL MINIMIZE DISTURBANCE INCLUDING RUTS PRODUCED BY VEHICLES AND EQUIPMENT IN NON-PAVEMENT AREAS WITHIN ALL CONSTRUCTION AREAS. ALL DISTURBED AREAS IN THESE LOCATIONS SHALL BE RECLAIMED AT NO ADDITIONAL COST TO THE SPONSOR. DAMAGE CAUSED TO EXISTING AIRFIELD PAVEMENT OR FACILITIES DURING CONSTRUCTION SHALL BE REPAIRED BY THE CONTRACTOR AT NO ADDITIONAL COST TO THE SPONSOR.
- CONTRACTOR SHALL COORDINATE ALL ON-SITE WASTE MATERIAL DISPOSAL WITH ENGINEER AND AIRPORT.
- ADD 4200 TO ALL PROPOSED CONTOUR AND SPOT ELEVATIONS.



**CAUTION - NOTICE TO CONTRACTOR**

THE CONTRACTOR IS SPECIFICALLY CAUTIONED THAT THE LOCATION AND/OR ELEVATION OF EXISTING UTILITIES AS SHOWN ON THESE PLANS IS BASED ON RECORDS OF THE VARIOUS UTILITY COMPANIES AND WHERE POSSIBLE, MEASUREMENTS IN THE FIELD. THE INFORMATION IS PROVIDED FOR THE CONVENIENCE OF THE CONTRACTOR AND IS NOT TO BE RELIED UPON AS BEING EXACT OR COMPLETE. THE CONTRACTOR MUST CALL BLUE STAKES OF UTAH (800-662-4111) AT LEAST 48 HOURS BEFORE ANY EXCAVATION/EMBANKMENT TO REQUEST FIELD LOCATION OF UTILITIES.

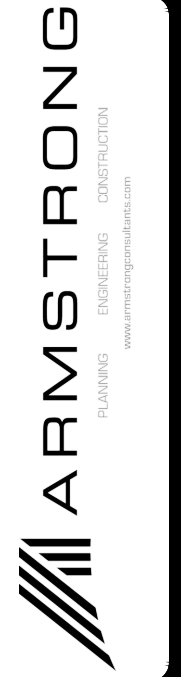

WEST DESERT AIRPORT  
FAIRFIELD, UTAH  
CONSTRUCTION PLANS  
TAXIWAY EXTENSION

No.	Revision	Date	By

ACI No. 206685  
Date: NOV. 2021  
File Name: 206685101

Drawn: MLM  
Checked: JPH  
Approved: DJH

GENERAL NOTES, LEGEND & SURVEY CONTROL

S:\Uton\West Desert Airport\Project Files\Active Projects\206685 - West Desert - Taxiway Extension\CAD\dwg\206685102.dwg 12/20/2021 9:01:21 AM MMONROE

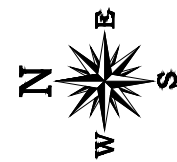
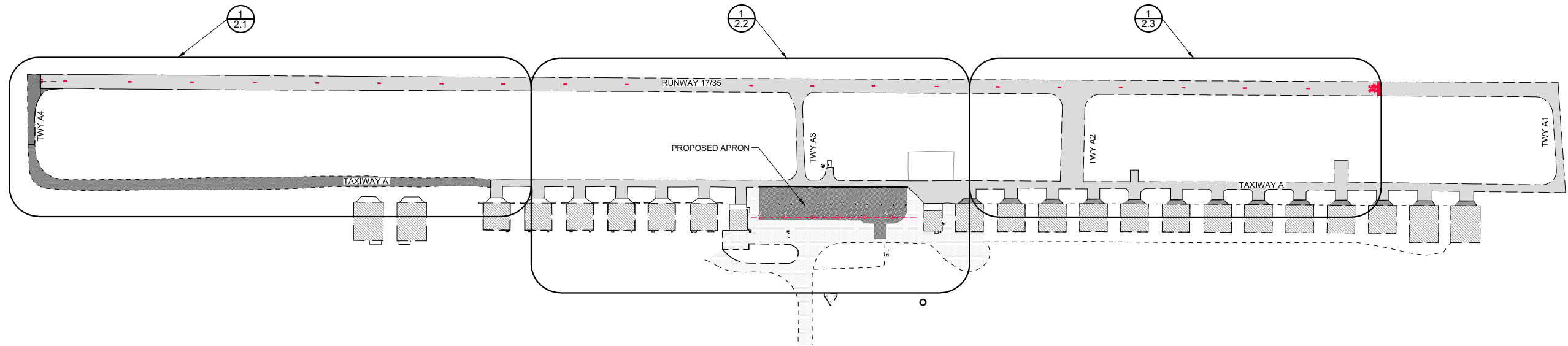

**GEOMETRIC LAYOUT ABBREVIATIONS**

PI	POINT OF INTERSECTION/POINT ON LINE
LT	LEFT
RT	RIGHT

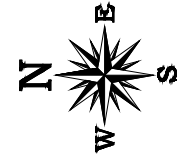
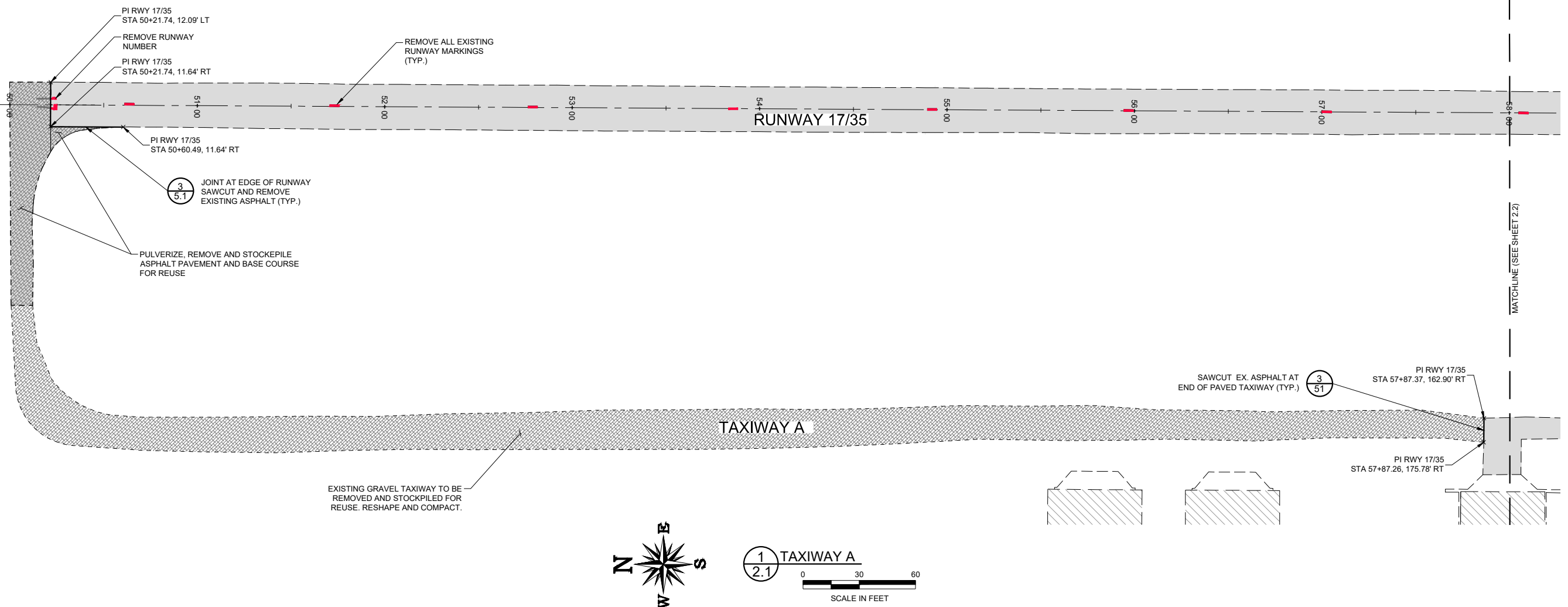

No.	Revision	Date	By

ACI No. 206685  
Date: NOV. 2021  
File Name: 206685102

Drawn: MLM  
Checked: JPH  
Approved: DJH

**DEMOLITION PLAN**

S:\\_Uton\West Desert Airport\Project Files\Active Projects\206685 - West Desert - Taxiway Extension\CAD\dwg\206685102.dwg 12/20/2021 9:01:21 AM MMONROE

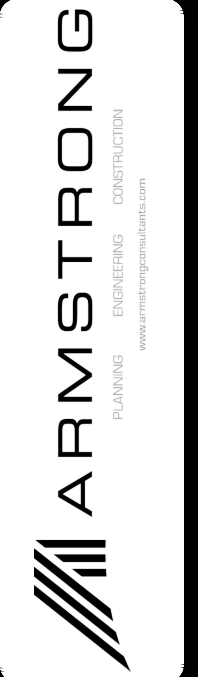
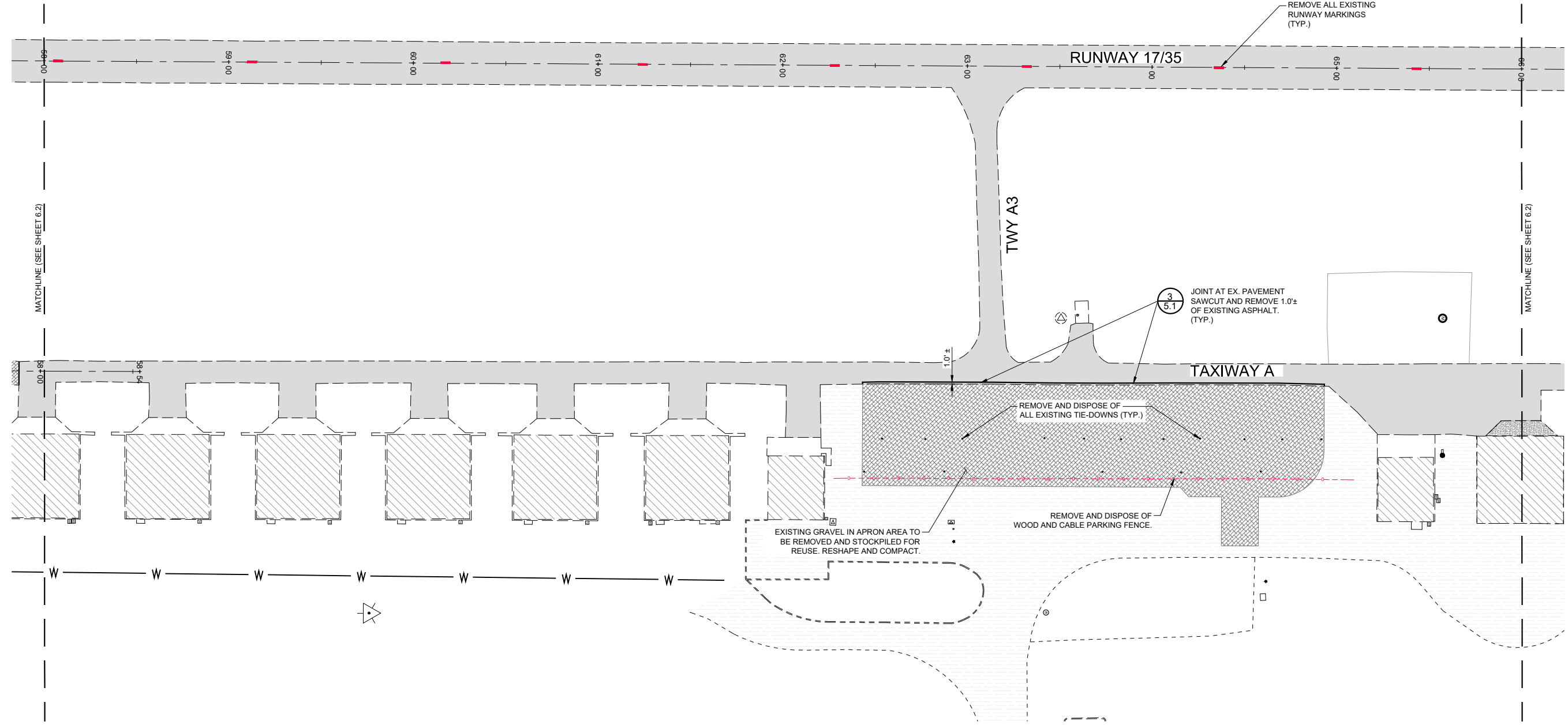

WEST DESERT AIRPORT  
FAIRFIELD, UTAH  
CONSTRUCTION PLANS  
TAXIWAY EXTENSION

No.	Revision	Date	By

ACI No. 206685  
Date: NOV. 2021  
File Name: 206685102

Drawn: MLM  
Checked: JPH  
Approved: DJH

DEMOLITION  
PLAN

Sheet: 2.2

S:\Uton\West Desert Airport\Project Files\Active Projects\206685 - West Desert - Taxiway Extension\CAD\dwg\206685102.dwg 12/20/2021 9:01:21 AM MMONROE

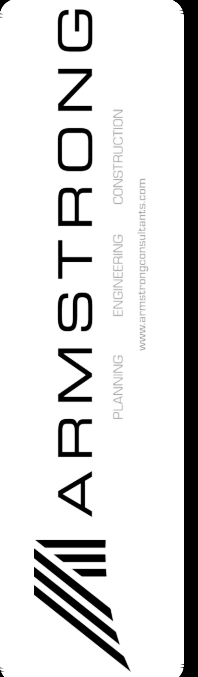
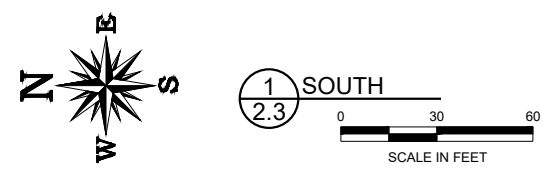
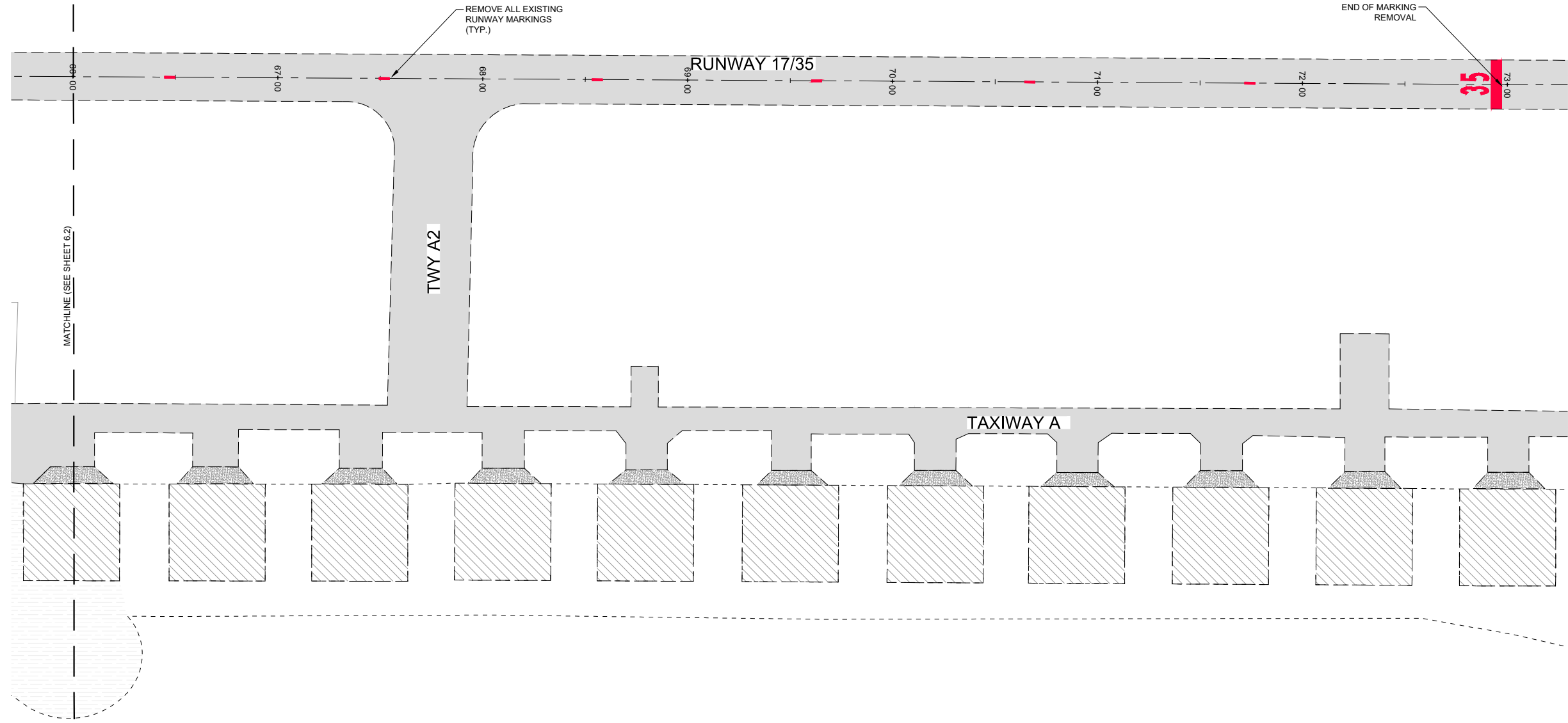

WEST DESERT AIRPORT  
FAIRFIELD, UTAH  
CONSTRUCTION PLANS  
TAXIWAY EXTENSION

No.	Revision	Date	By

ACI No. 206685  
Date: NOV. 2021  
File Name: 206685102

Drawn: MLM  
Checked: JPH  
Approved: DJH

DEMOLITION  
PLAN

Sheet: 2.3

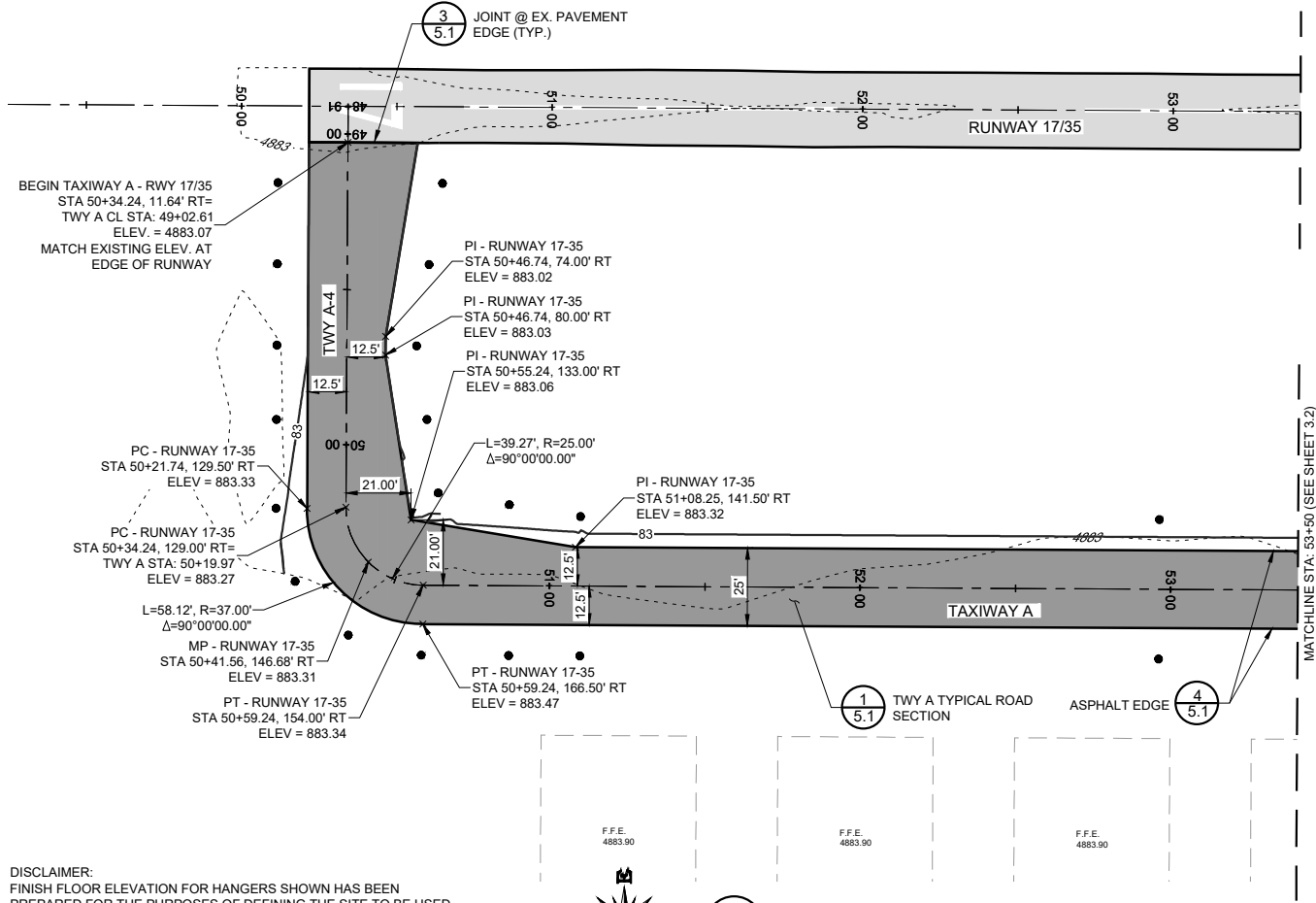
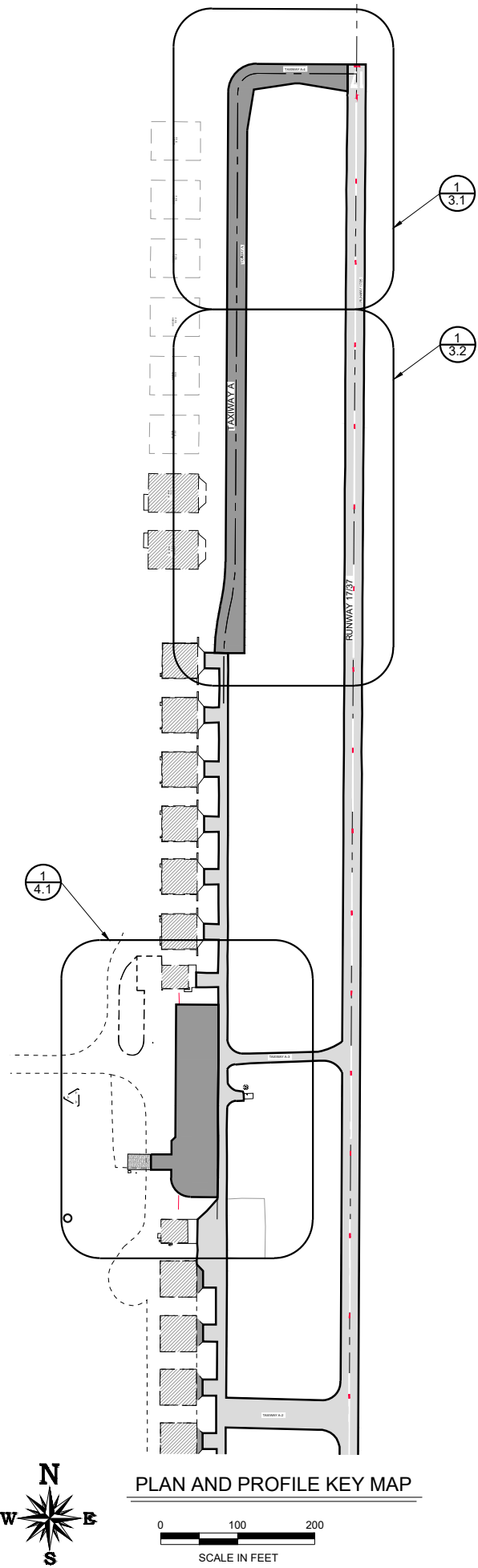

DISCLAIMER:  
FINISH FLOOR ELEVATION FOR HANGERS SHOWN HAS BEEN PREPARED FOR THE PURPOSES OF DEFINING THE SITE TO BE USED FOR A HANGER. PLEASE NOTE THAT THE INFORMATION PROVIDED HEREIN IS PRELIMINARY IN NATURE AND SHOULD BE VERIFIED BASED ON ACTUAL DESIGN OF THE PROPOSED DEVELOPMENT.

**NOTES AND ABBREVIATIONS**

PI	POINT OF INTERSECTION/POINT ON LINE
PT	POINT OF TANGENCY
PC	POINT OF CURVATURE
RP	RADIUS POINT
MP	MID POINT
RT	RIGHT

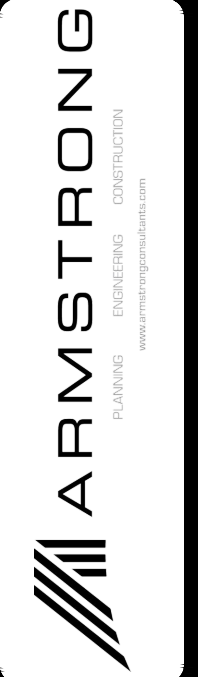
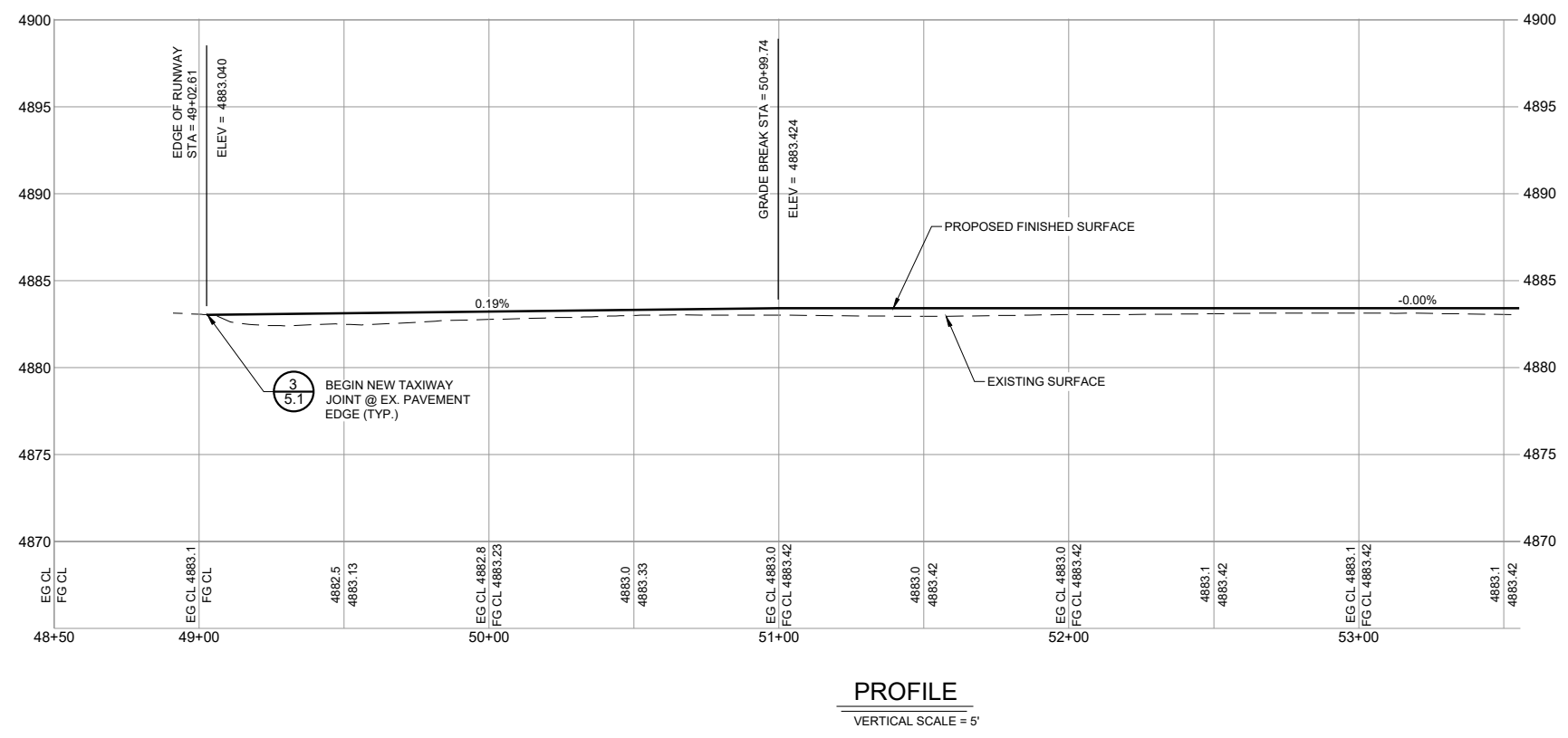

WEST DESERT AIRPORT  
FAIRFIELD, UTAH  
CONSTRUCTION PLANS  
TAXIWAY EXTENSION

No.	Revision	Date	By

ACI No. 206685  
Date: NOV. 2021  
File Name: 206685103

Drawn: MLM  
Checked: JPH  
Approved: DJH

TAXIWAY A  
PLAN AND  
PROFILE

S:\Utah\West Desert Airport\Project Files\Active Projects\206685 - West Desert - Taxiway Extension\CAD\dwg\206685103.dwg 12/17/2021 11:20:49 AM MMONROE

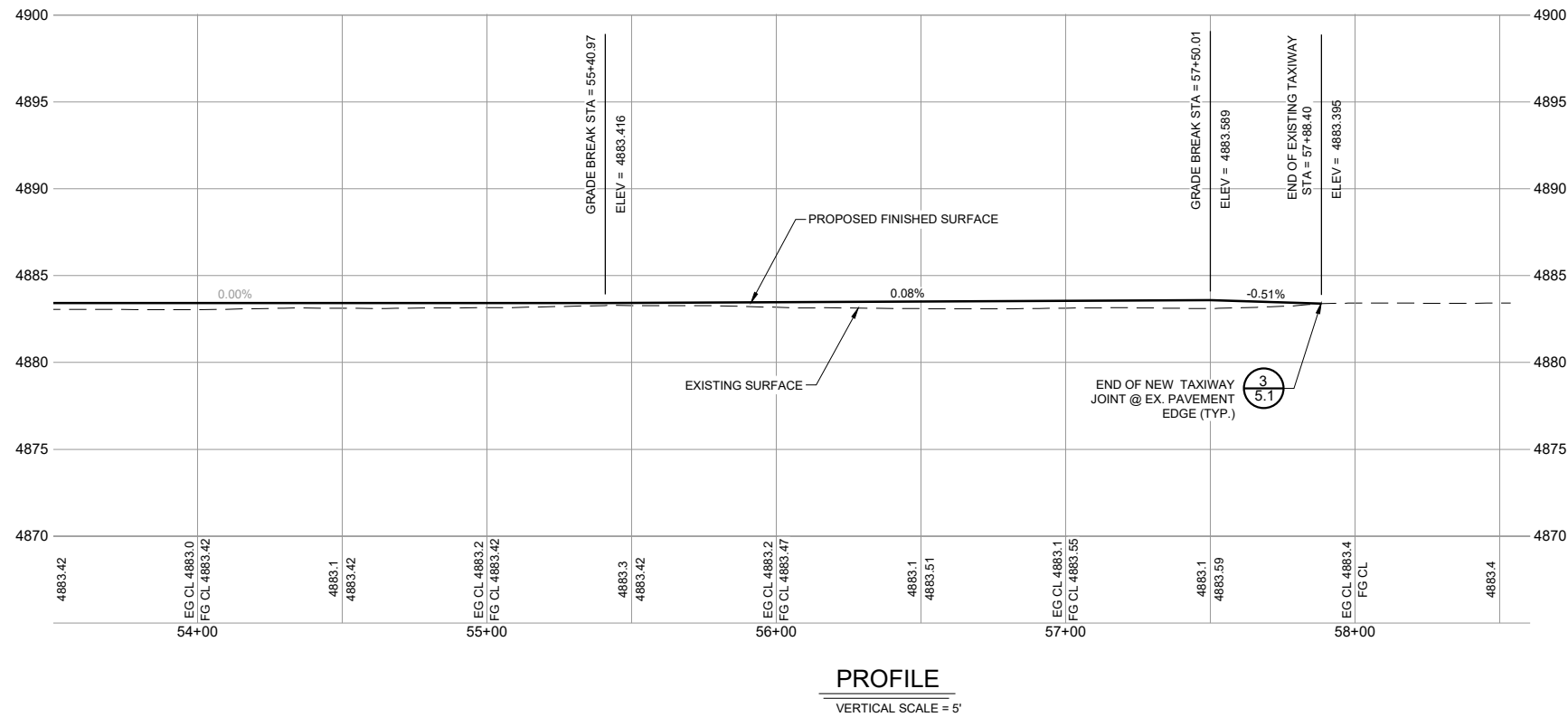
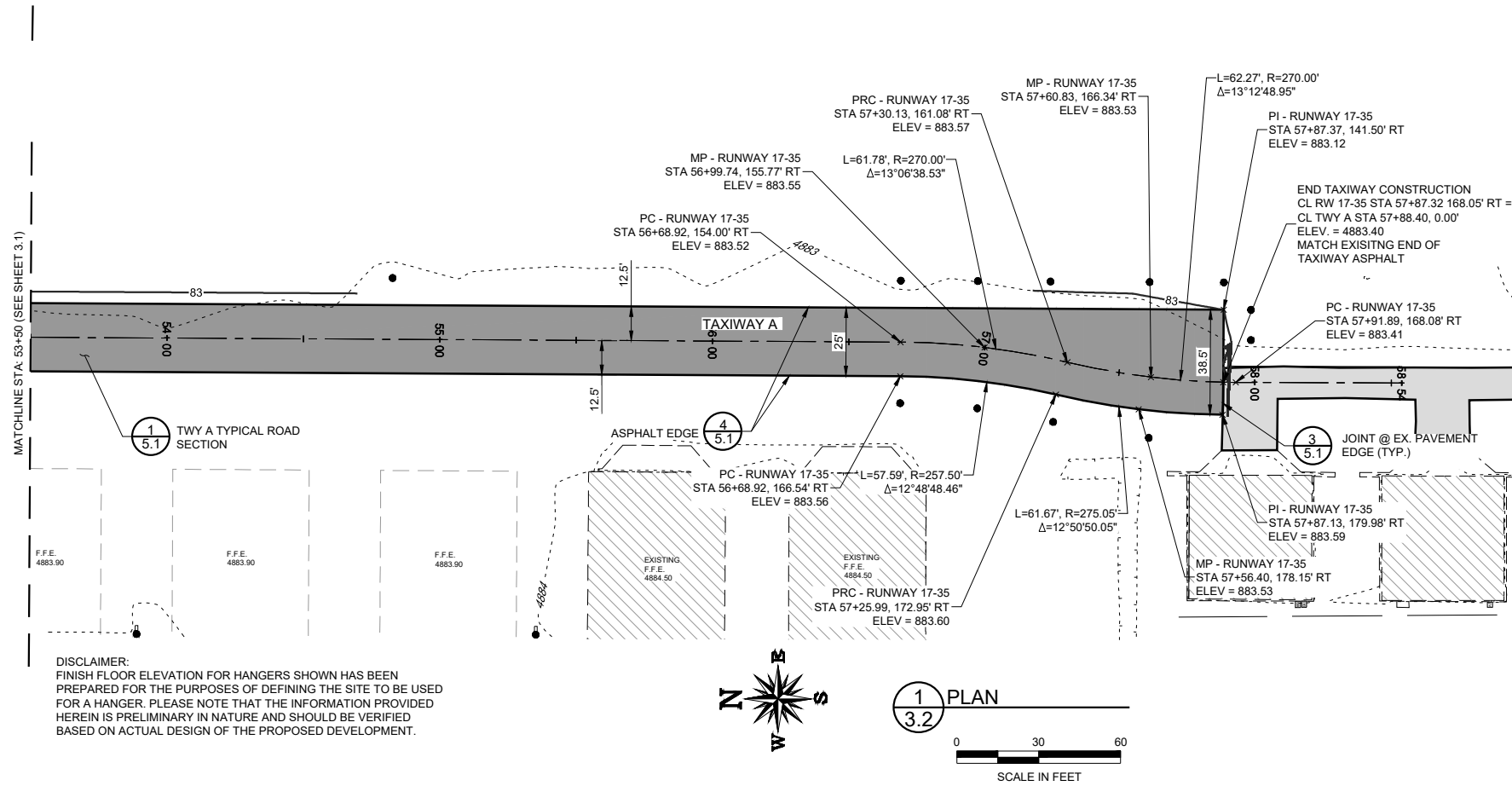

No.	Revision	Date	By

ACI No. 206685  
Date: NOV. 2021  
File Name: 206685103

Drawn: MLM  
Checked: JPH  
Approved: DJH

TAXIWAY A  
PLAN AND  
PROFILE

S:\Utah\West Desert Airport\Project Files\Active Projects\206685 - West Desert - Taxiway Extension\CAD\dwg\206685103.dwg 12/16/2021 4:59:31 PM MMONROE

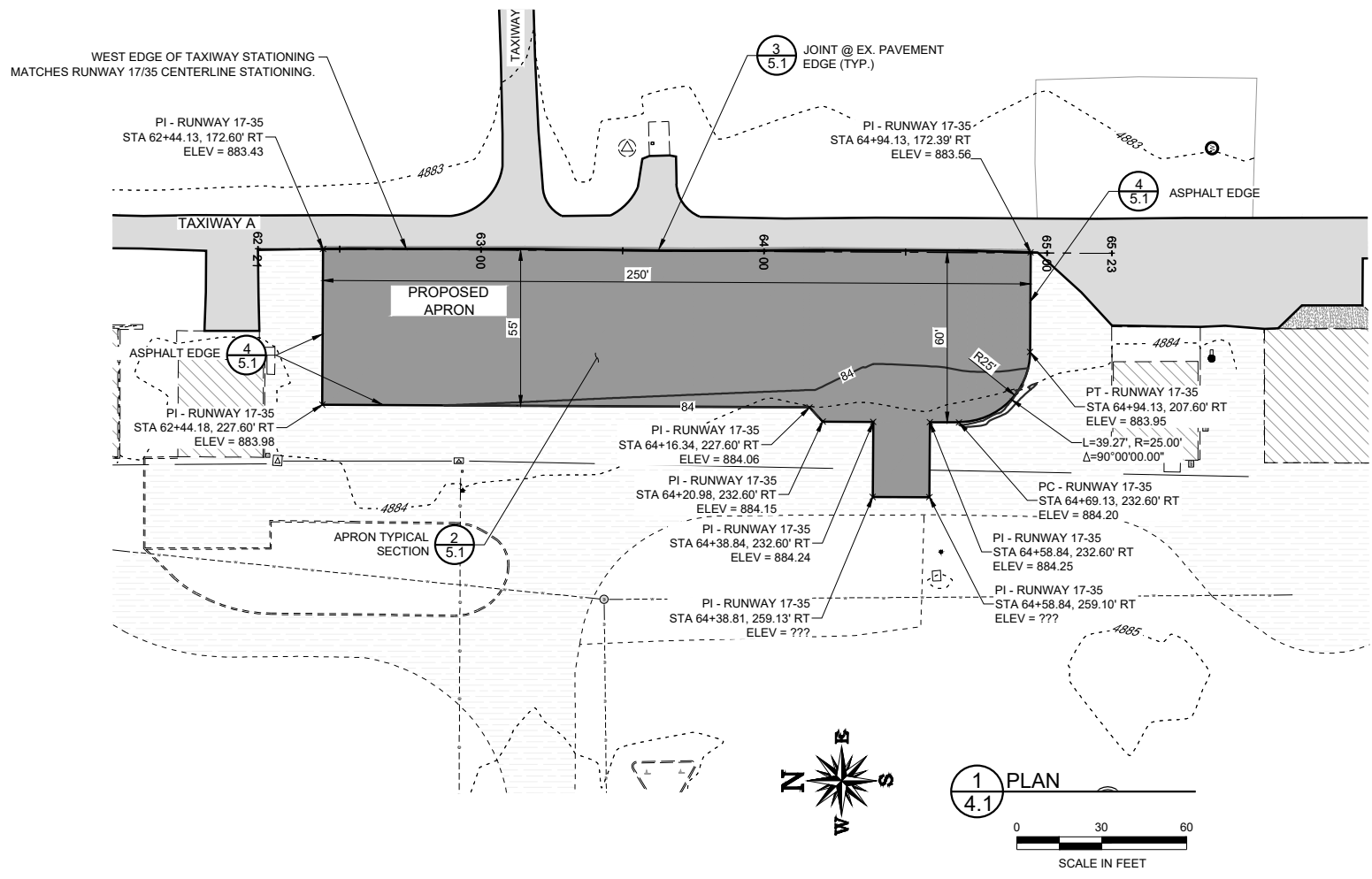

**NOTES AND ABBREVIATIONS**

PI	POINT OF INTERSECTION/POINT ON LINE
PT	POINT OF TANGENCY
PC	POINT OF CURVATURE
RT	RIGHT

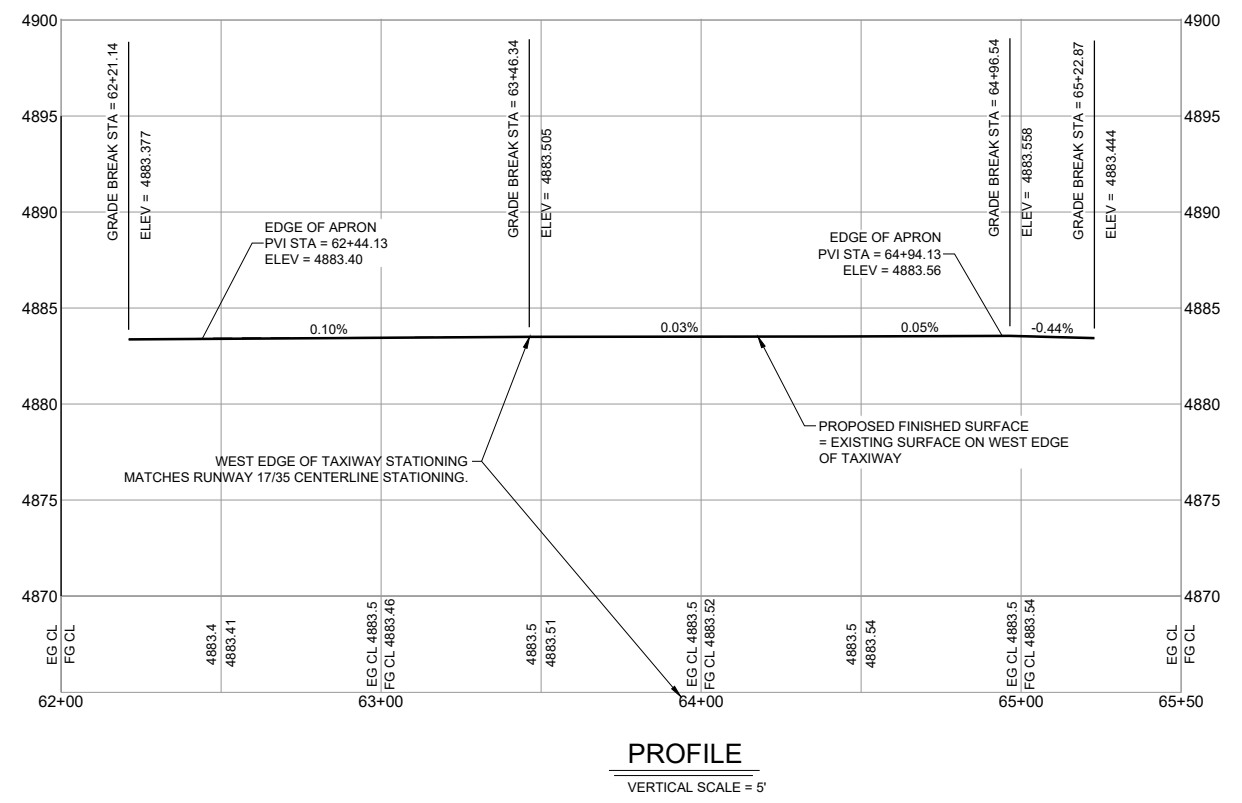

No.	Revision	Date	By

ACI No. 206685  
Date: NOV. 2021  
File Name: 206685103

Drawn: MLM  
Checked: JPH  
Approved: DJH

APRON  
PLAN AND  
PROFILE



S:\Utah\West Desert Airport\Project Files\Active Projects\206685 - West Desert - Taxiway Extension\CAD\dwg\206685103.dwg 2/10/2022 5:01:42 PM MMONROE

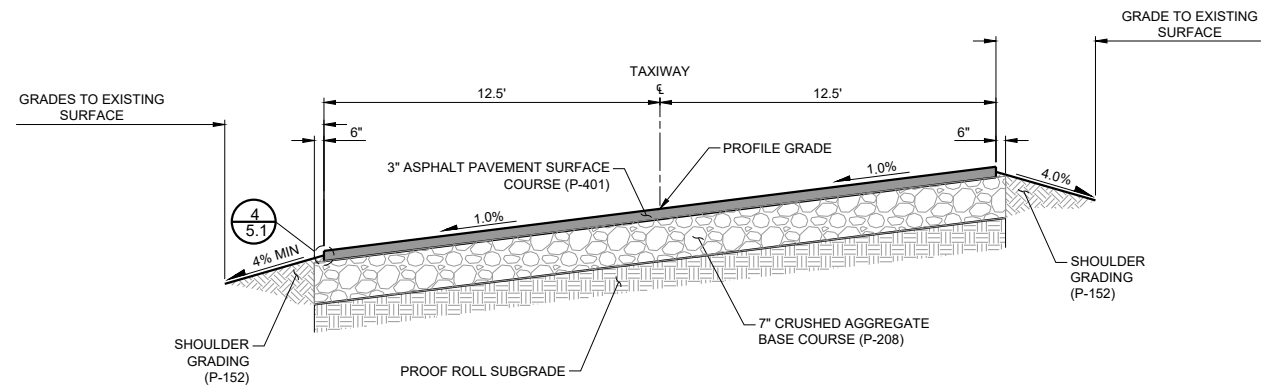

**1 TAXIWAY A TYPICAL SECTION**  
 5.1 NOT TO SCALE  
 SEE TYPICAL SECTION NOTE

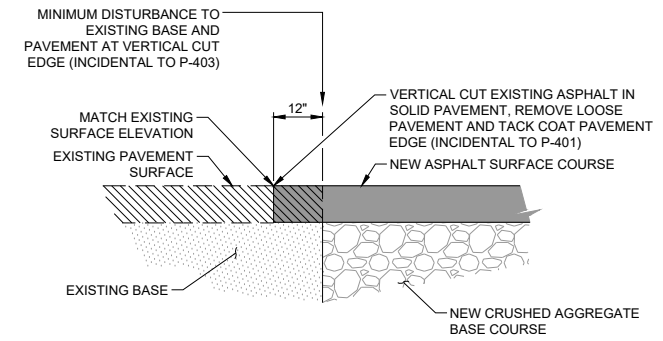

**3 JOINT AT EXISTING PAVEMENT EDGE**  
 5.1 NOT TO SCALE

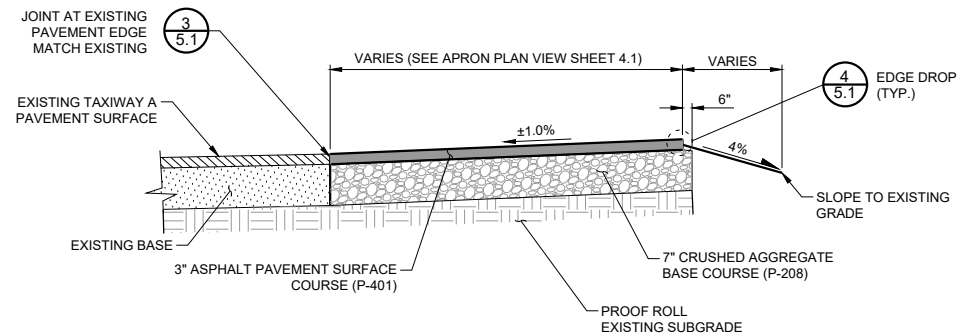

**2 APRON @ TAXIWAY "A" TYPICAL SECTION**  
 5.1 NOT TO SCALE  
 SEE TYPICAL SECTION NOTE

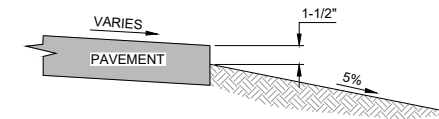

**4 PAVEMENT EDGE DROP**  
 5.1 NOT TO SCALE

**TYPICAL SECTION NOTE**  
 WITH AIRPORT APPROVAL:

\*P-401 MATERIAL MAY BE SUBSTITUTED WITH HMA MATERIAL PER UDOT-2022 STANDARD SPECIFICATIONS, SECTION 02741, 1/2 INCH MINUS GRADATION OR LARGER

\*P-208 MATERIAL MAY BE SUBSTITUTED WITH UTBC MATERIAL PER UDOT-2022 STANDARD SPECIFICATIONS, SECTION 02721, AGGREGATE CLASS A

\*P-152 MATERIAL MAY BE SUBSTITUTED WITH GRANULAR BORROW PER UDOT-2022 STANDARD SPECIFICATIONS, SECTION 02056, 2.2.B; OR AGGREGATE BASE COURSE

No.	Revision	Date	By

ACI No. 206685  
 Date: NOV. 2021  
 File Name: 206685103

Drawn: MLM  
 Checked: JPH  
 Approved: DJH

DETAILS

S:\Uton\West Desert Airport\Project Files\Active Projects\206685 - West Desert - Taxiway Extension\CAD\dwg\206685104.dwg 12/20/2021 10:42:57 AM MMONROE

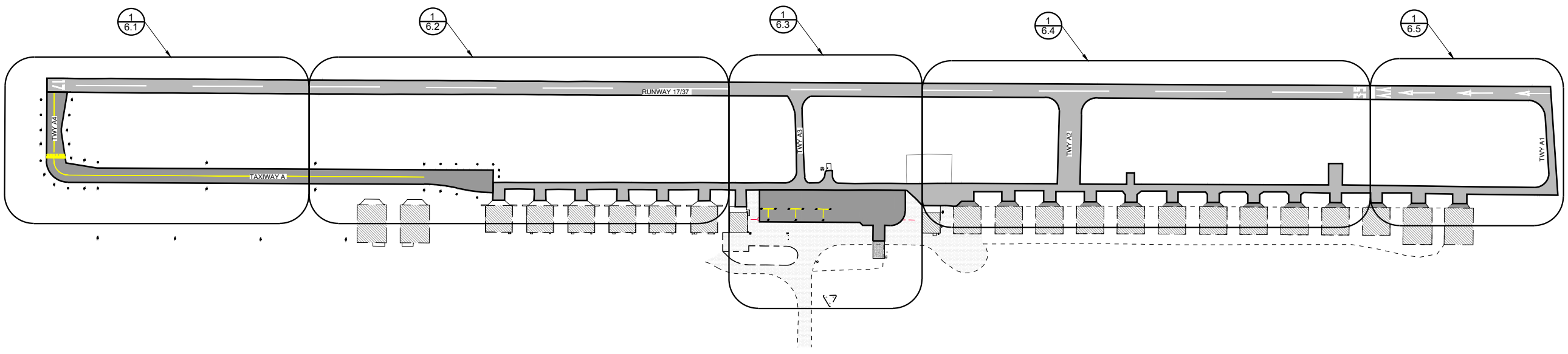

- NOTES AND ABBREVIATIONS**
- PI POINT OF INTERSECTION/ POINT ON LINE
  - PC POINT OF CURVATURE
  - PT POINT OF TANGENCY
  - RT RIGHT

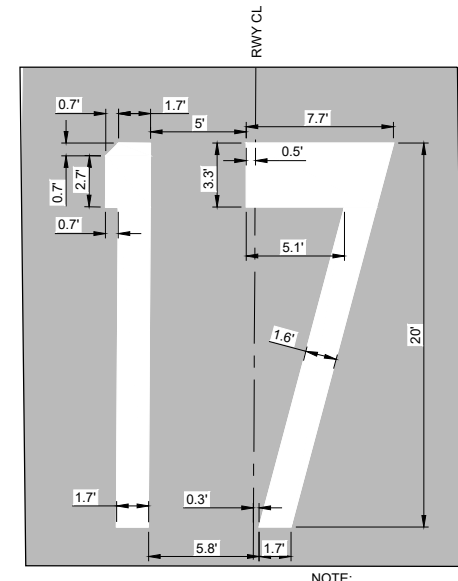
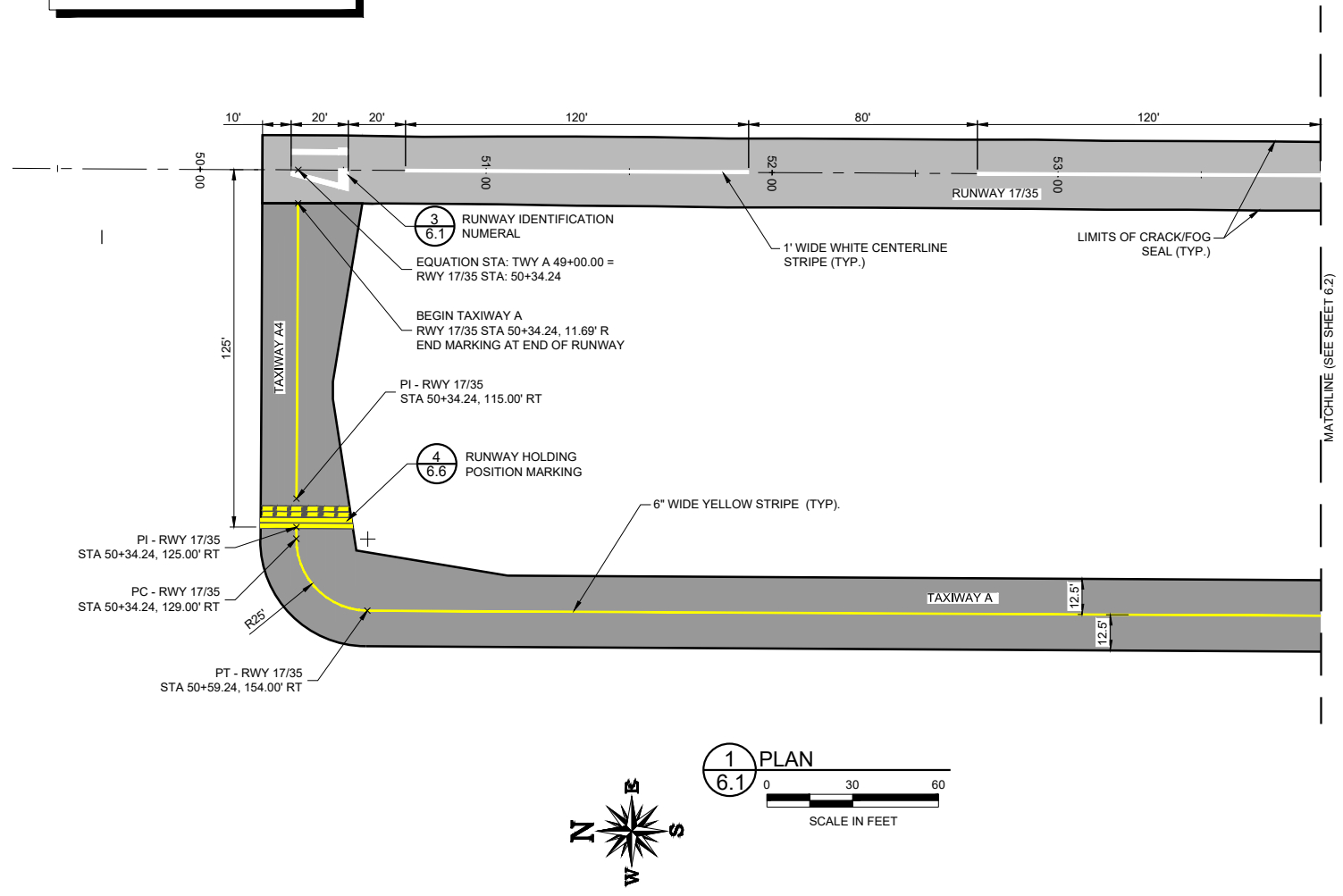

3  
6.1  
NUMERALS DETAIL  
NOT TO SCALE

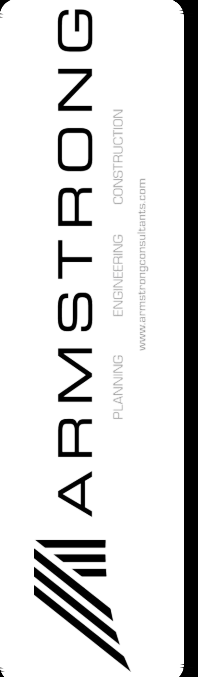

WEST DESERT AIRPORT  
FAIRFIELD, UTAH  
CONSTRUCTION PLANS  
TAXIWAY EXTENSION

No.	Revision	Date	By

ACI No. 206685  
Date: NOV. 2021  
File Name: 206685104

Drawn: MLM  
Checked: JPH  
Approved: DJH

MARKING PLAN

Sheet: 6.1

S:\Uton\West Desert Airport\Project Files\Active Projects\206685 - West Desert - Taxiway Extension\CAD\dwg\206685104.dwg 12/20/2021 10:42:57 AM MMONROE

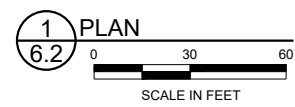
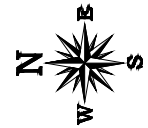
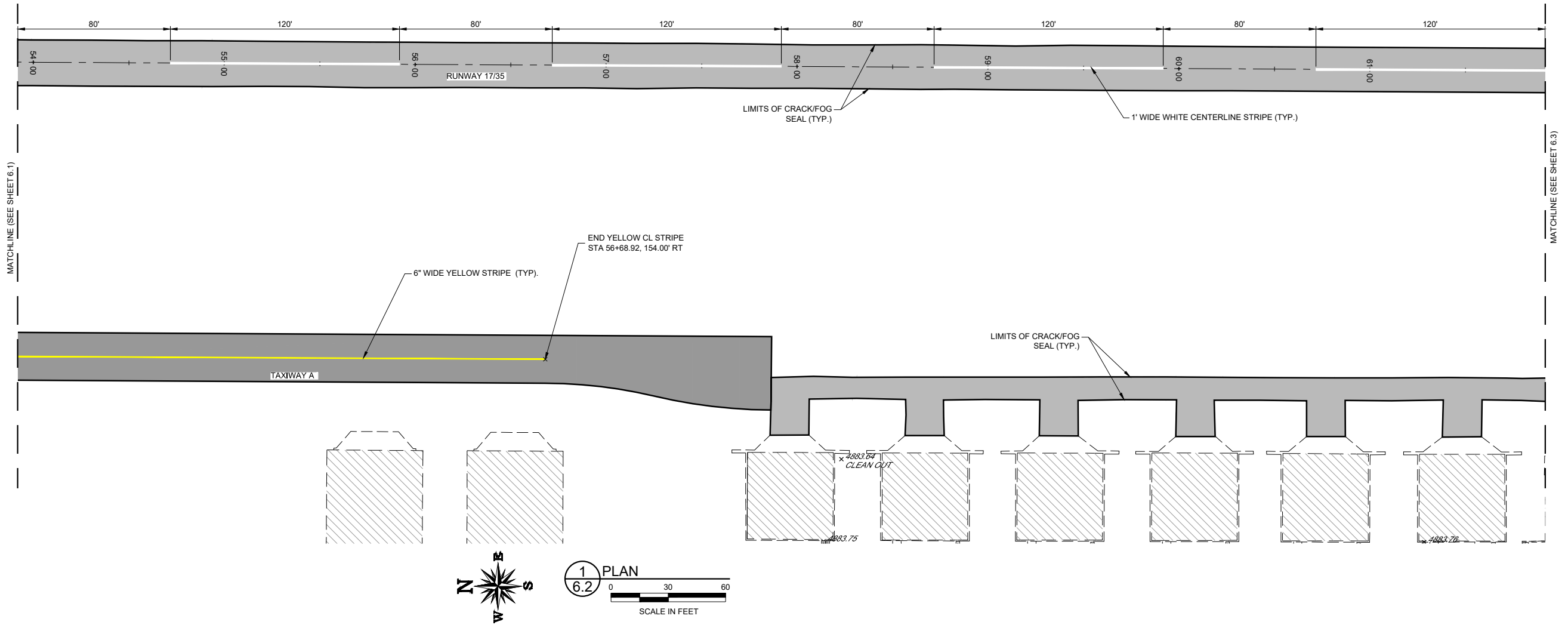

NOTES AND ABBREVIATIONS	
PC	POINT OF CURVATURE
PRC	POINT OF REVERSE CURVATURE
RT	RIGHT



WEST DESERT AIRPORT  
FAIRFIELD, UTAH  
CONSTRUCTION PLANS  
TAXIWAY EXTENSION

No.	Revision	Date	By

ACI No. 206685  
Date: NOV. 2021  
File Name: 206685104

Drawn: MLM  
Checked: JPH  
Approved: DJH

MARKING  
PLAN

Sheet: 6.2

S:\Uton\West Desert Airport\Project Files\Active Projects\206685 - West Desert - Taxiway Extension\CAD\dwg\206685104.dwg 12/20/2021 10:42:57 AM MMONROE

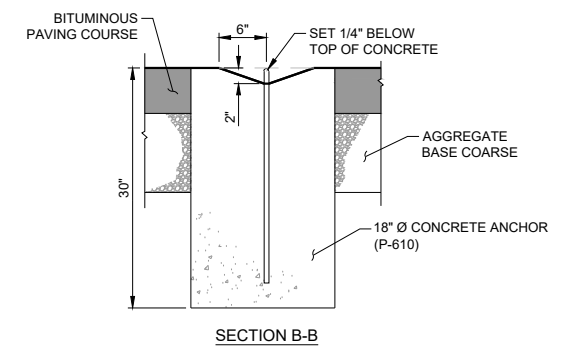
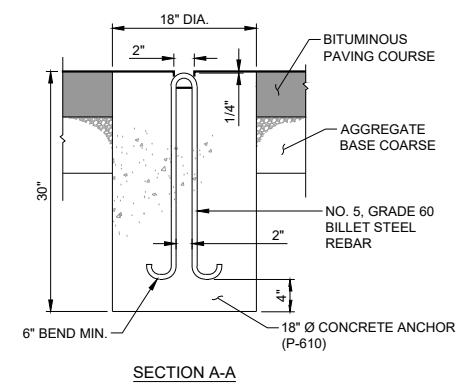
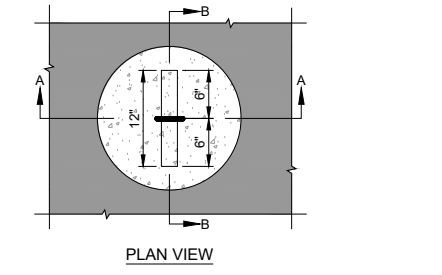
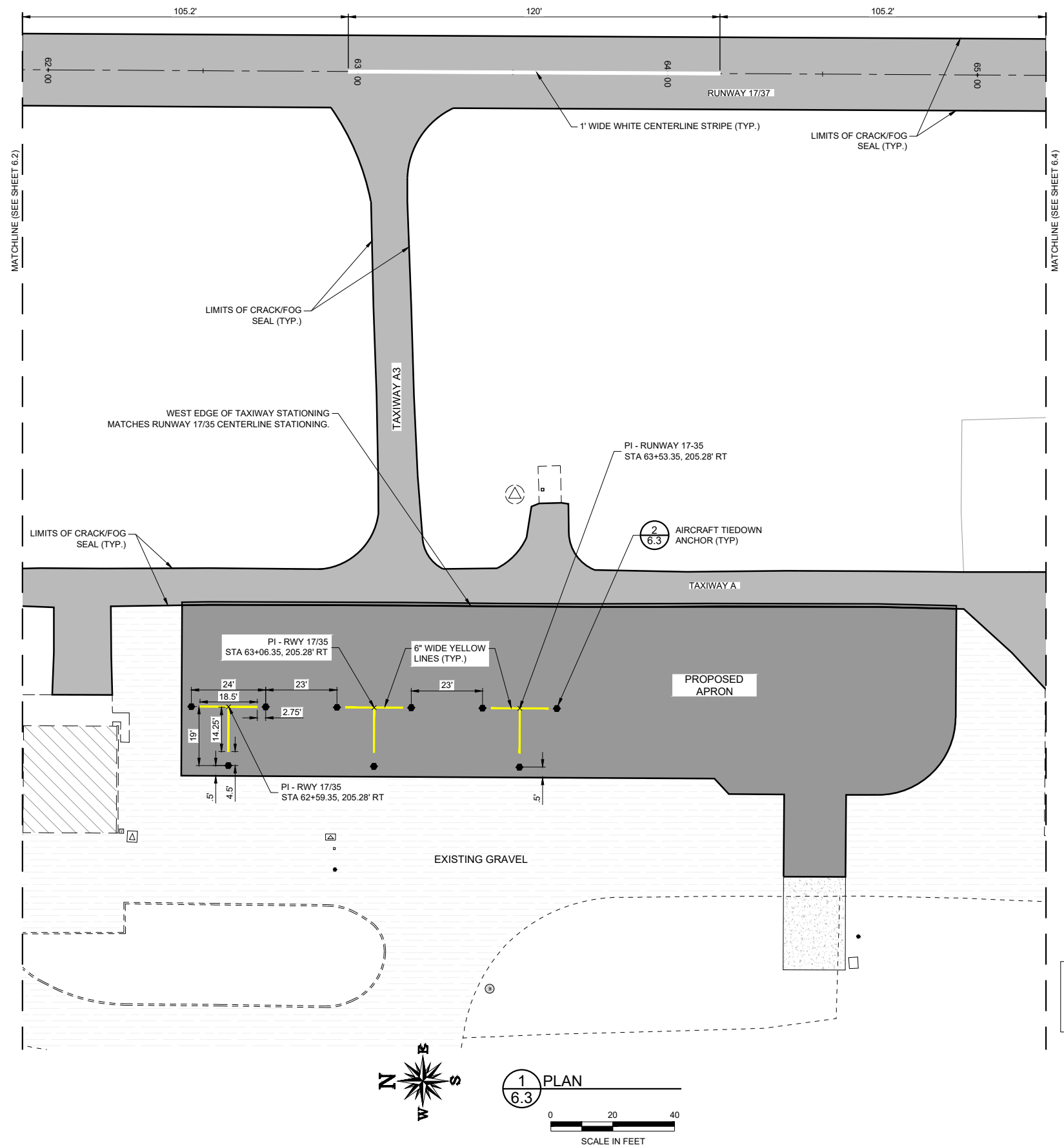

2 AIRCRAFT TIEDOWN DETAIL  
6.3 NOT TO SCALE

**NOTES AND ABBREVIATIONS**  
ALL ANCHOR PAD DIMENSIONS ARE TYPICAL  
PI POINT OF INTERSECTION/POINT ON LINE

No.	Revision	Date	By

ACI No. 206685  
Date: NOV. 2021  
File Name: 206685104

Drawn: MLM  
Checked: JPH  
Approved: DJH

S:\Uton\West Desert Airport\Project Files\Active Projects\206685 - West Desert - Taxiway Extension\CAD.dwg 12/20/2021 10:42:57 AM MCONROE

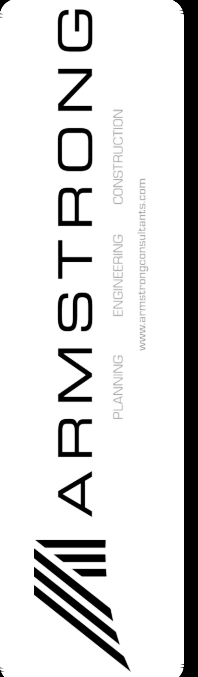
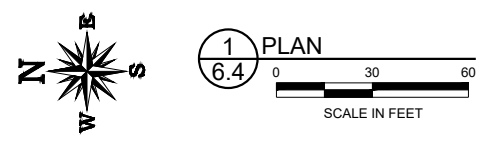
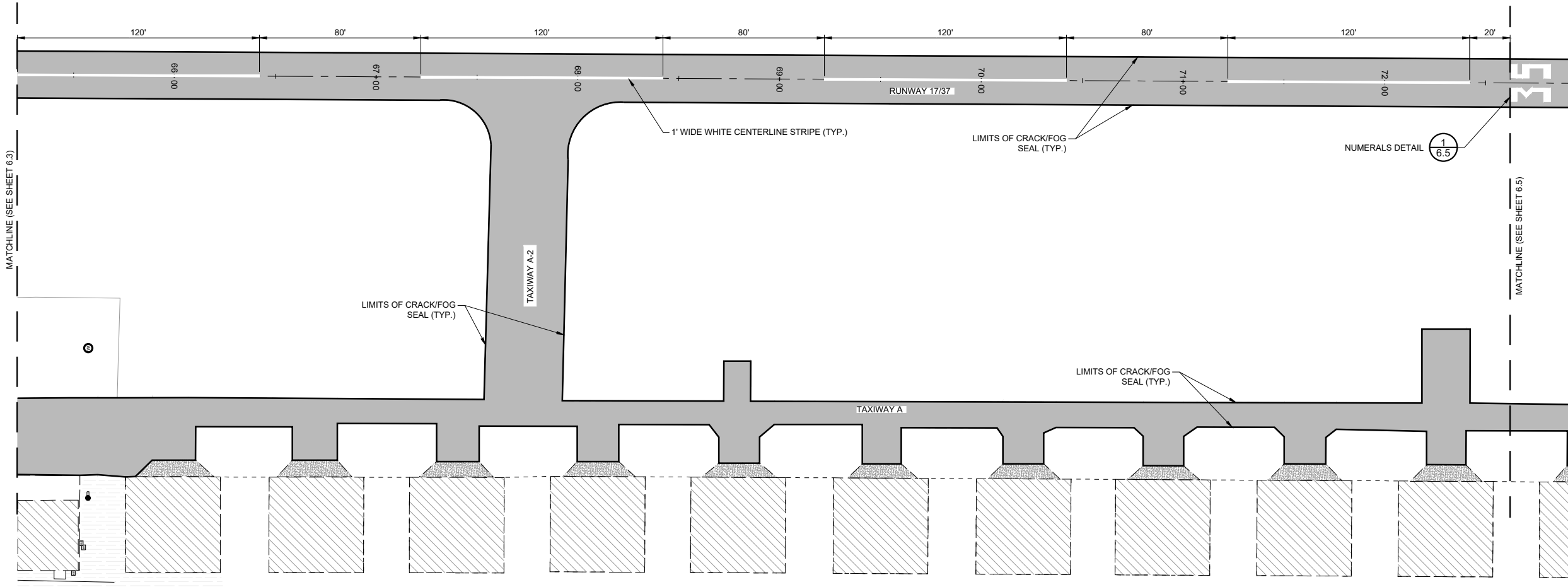

WEST DESERT AIRPORT  
FAIRFIELD, UTAH  
CONSTRUCTION PLANS  
TAXIWAY EXTENSION

No.	Revision	Date	By

ACI No. 206685  
Date: NOV. 2021  
File Name: 206685104

Drawn: MLM  
Checked: JPH  
Approved: DJH

MARKING  
PLAN

Sheet: 6.4

S:\\_Uton\West Desert Airport\Project Files\Active Projects\206685 - West Desert - Taxiway Extension\CAD\dwg\206685104.dwg 12/20/2021 10:42:57 AM MMONROE

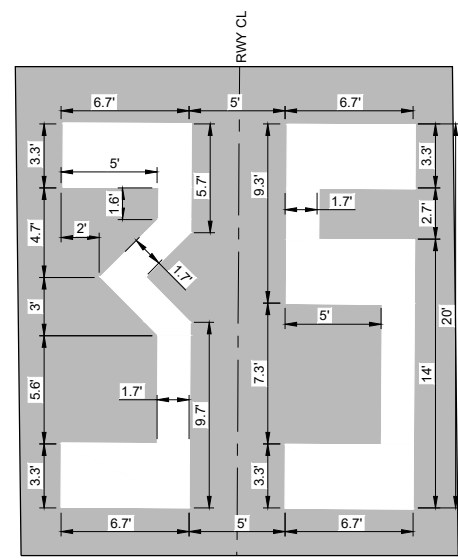
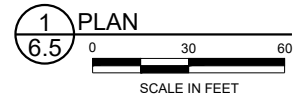
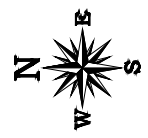
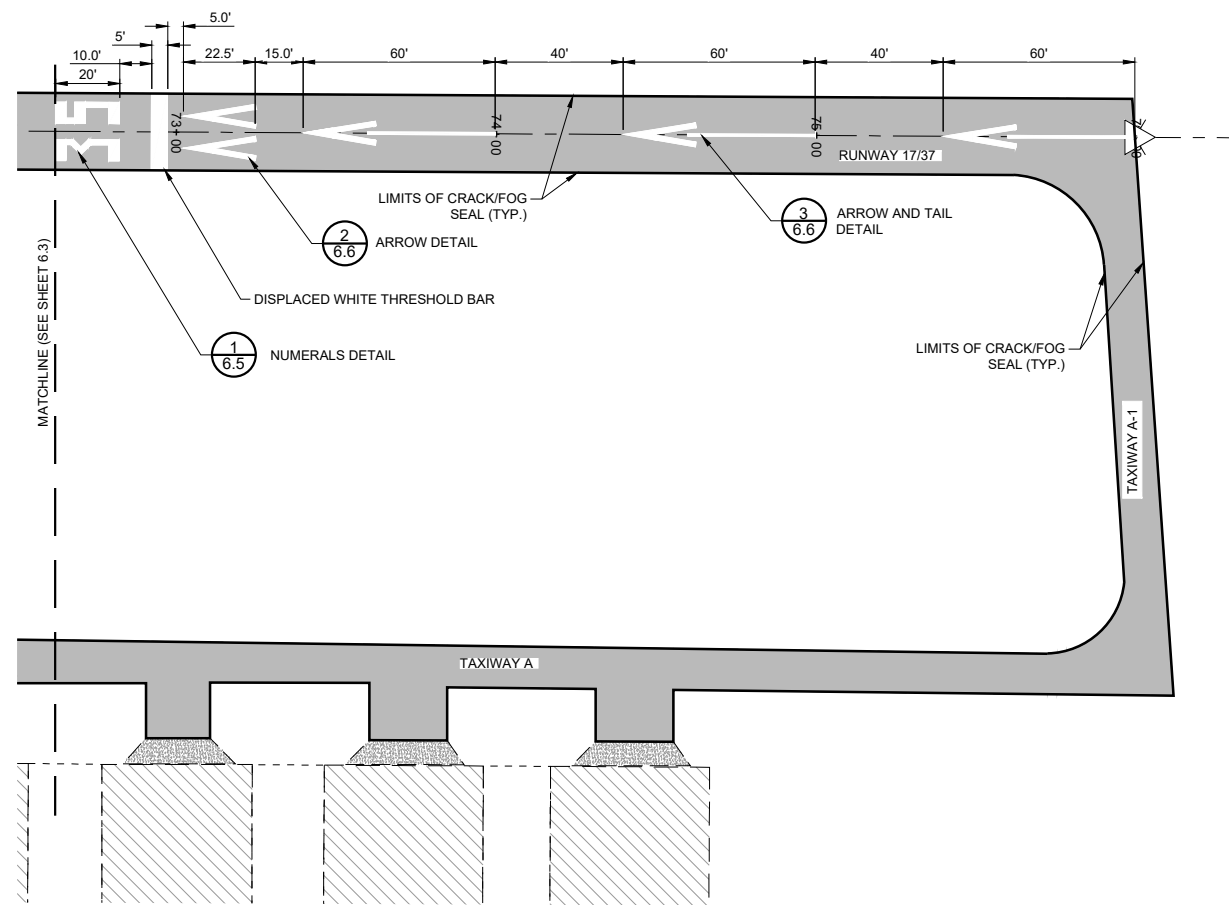

NOTE:  
ALL NUMERALS TO BE  
PAINTED WHITE

**1**  
**6.5** NUMERALS DETAIL  
NOT TO SCALE

No.	Revision	Date	By

ACI No. 206685  
Date: NOV. 2021  
File Name: 206685104

Drawn: MLM  
Checked: JPH  
Approved: DJH

MARKING  
PLAN

S:\Uton\West Desert Airport\Project Files\Active Projects\206685 - West Desert - Taxiway Extension\CAD\dwg\206685104.dwg 12/20/2021 10:42:57 AM MMONROE

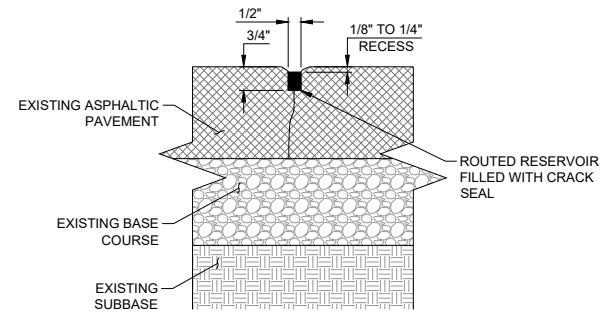

CRACKS 1/8" - 1/2" TREATMENT

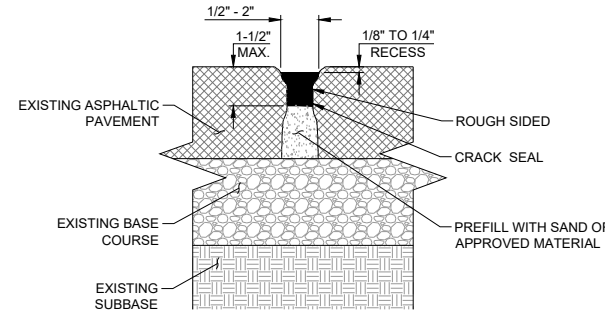

CRACKS 1/2" - 2" TREATMENT

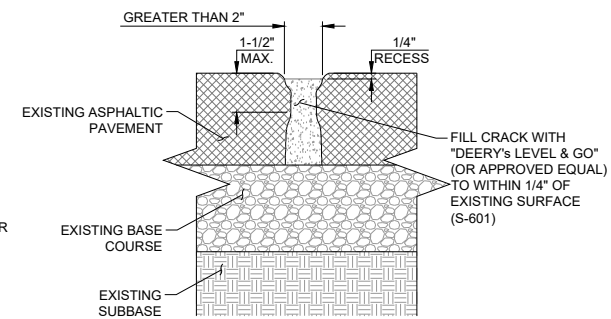

CRACKS LARGER THAN 2" TREATMENT

1 P-101 CRACK SEALING  
6.6 NOT TO SCALE

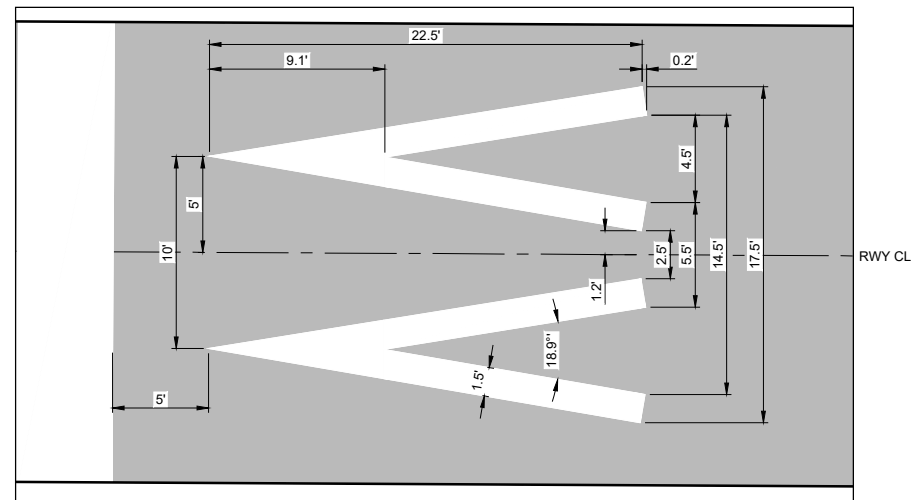

NOTE:  
ALL ARROWS TO BE PAINTED  
WHITE

2 RUNWAY ARROW DETAIL  
6.6 NOT TO SCALE

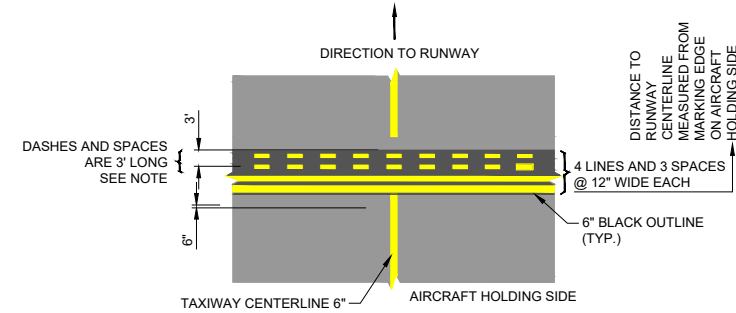

4 RUNWAY HOLDING POSITION MARKING - PATTERN A  
6.6 NOT TO SCALE

NOTES:  
UNLESS OTHERWISE NOTED ALL LINES ARE YELLOW.  
BLACK BACKGROUND TO BE CONTINUOUS BETWEEN  
LINES & STRIPES.

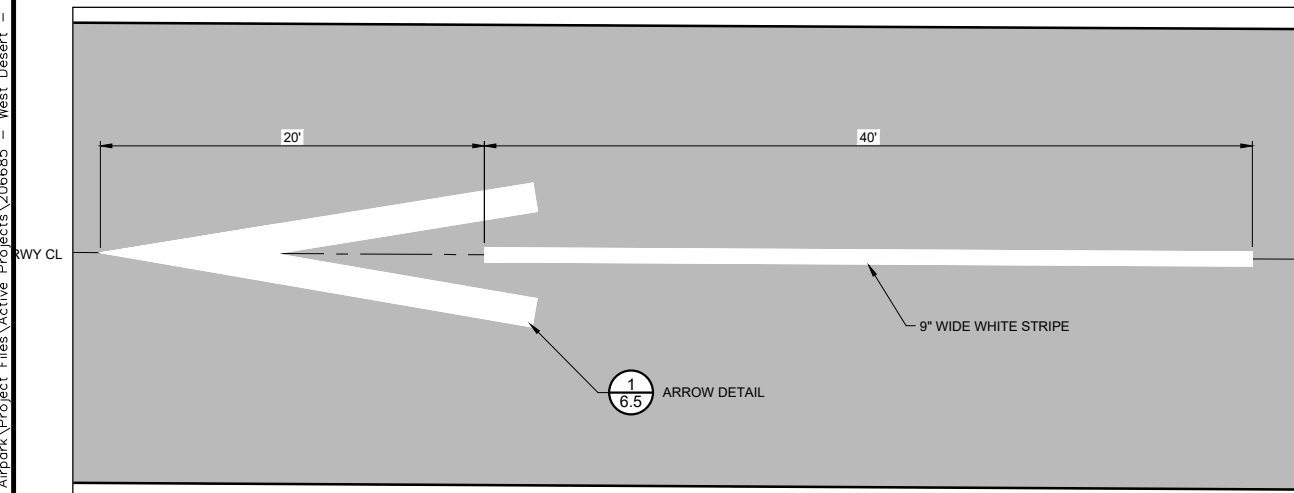

NOTE:  
ALL ARROWS AND TAILS TO BE  
PAINTED WHITE

3 RUNWAY ARROW AND TAIL DETAIL  
6.6 NOT TO SCALE

1 ARROW DETAIL  
6.5

No.	Revision	Date	By

ACI No. 206685  
Date: NOV. 2021  
File Name: 206685104

Drawn: MLM  
Checked: JPH  
Approved: DJH

DETAILS

S:\Uton\West Desert Airport\Project Files\Active Projects\206685 - West Desert - Taxiway Extension\CAD\dwg\206685104.dwg 12/20/2021 10:42:57 AM MMONROE

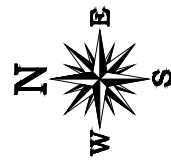
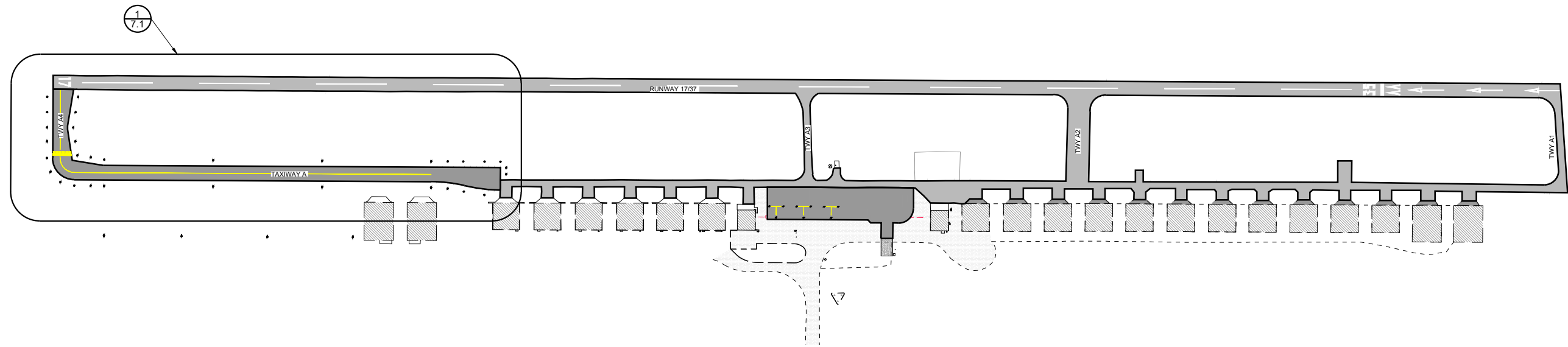

KEY MAP

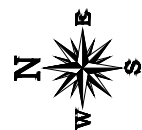
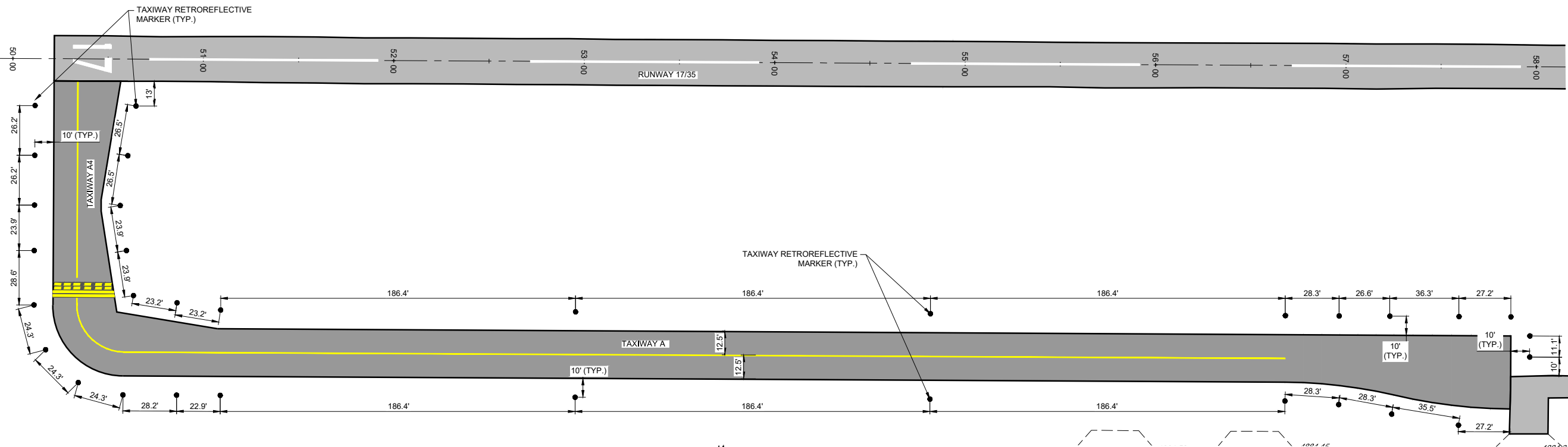

1 PLAN  
7.1

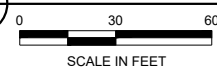

No.	Revision	Date	By

ACI No. 206685  
Date: NOV. 2021  
File Name: 206685104

Drawn: MLM  
Checked: JPH  
Approved: DJH

RETROREFLECTIVE  
TAXIWAY EDGE  
MARKER LAYOUT



S:\Uton\West\_Desert\_Airpark\Project\_Files\Active\_Projects\206685 - West\_Desert - Taxiway\_Extension\CAD\dwg\206685105.dwg 12/17/2021 9:28:17 AM MMONROE

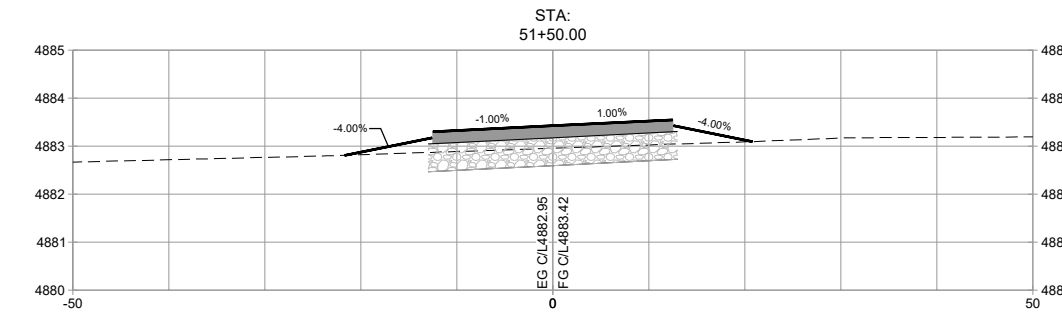
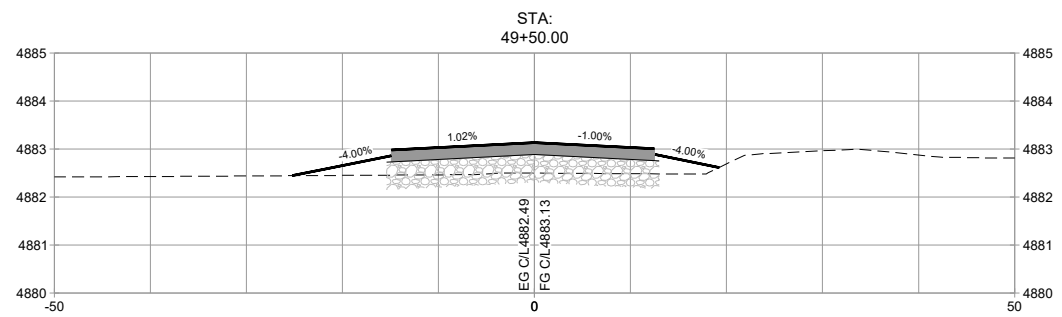
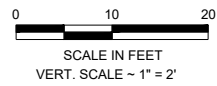
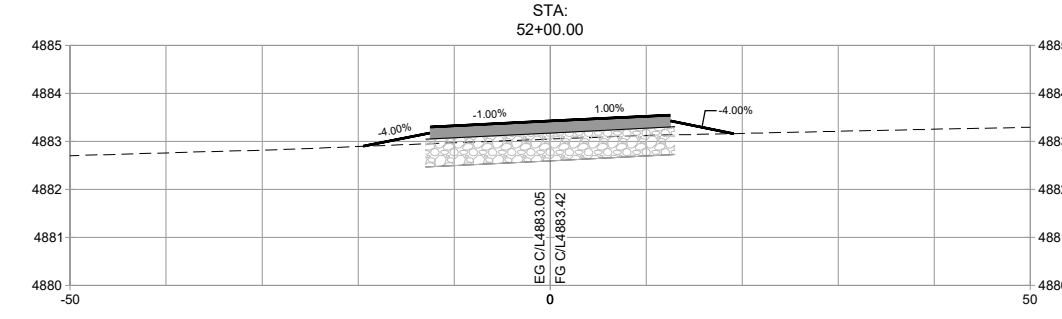
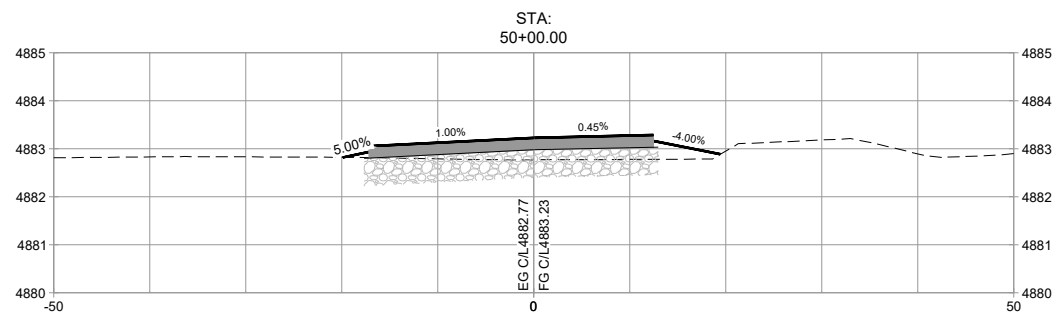
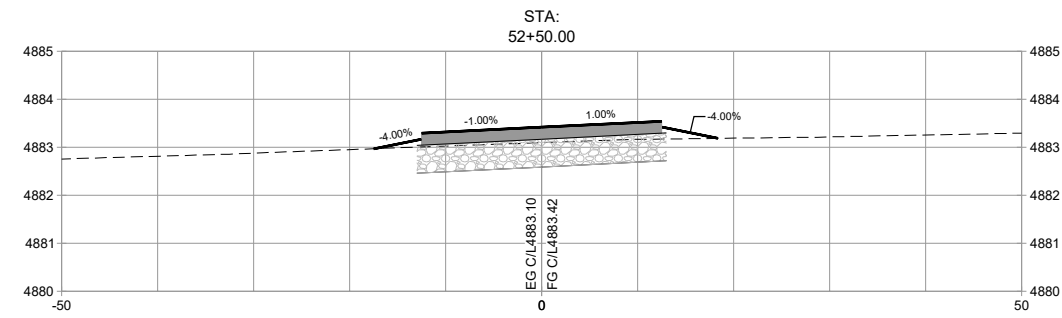
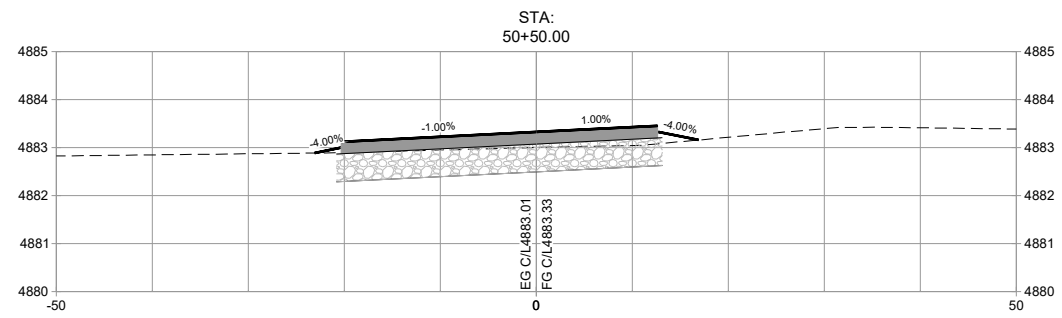
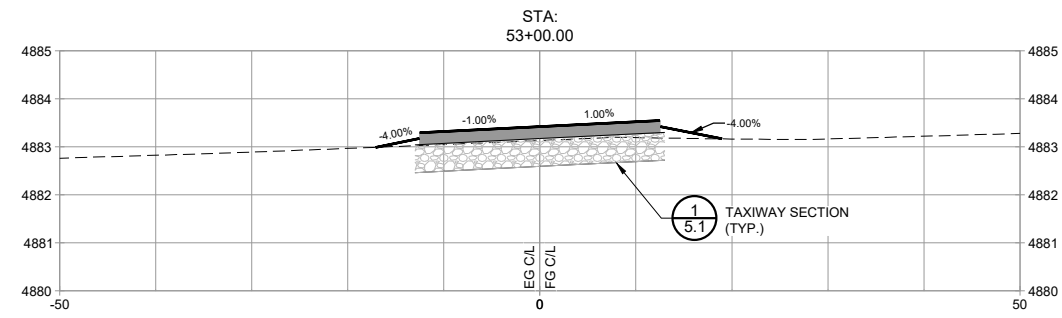
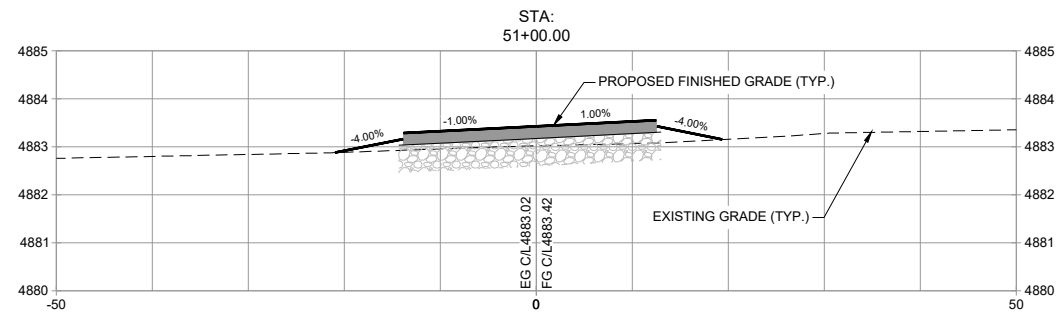

No.	Revision	Date	By

ACI No. 206685  
Date: NOV. 2021  
File Name: 206685105

Drawn: MLM  
Checked: JPH  
Approved: DJH

TAXIWAY A  
SECTIONS

S:\Uton\West\_Desert\_Airport\Project\_Files\Active\_Projects\206685 - West\_Desert - Taxiway\_Extension\CAD\_dwg\206685105.dwg 12/17/2021 9:28:17 AM MMONROE

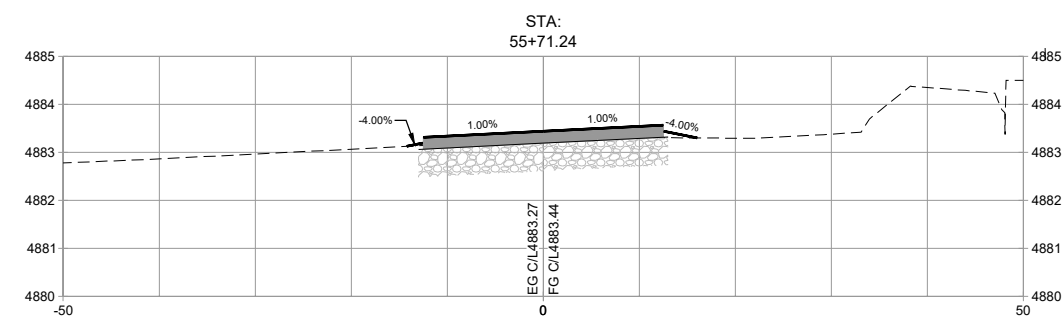
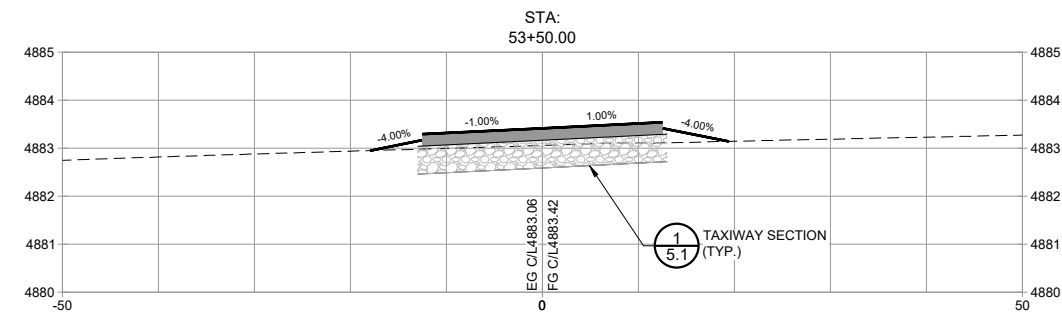
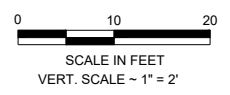
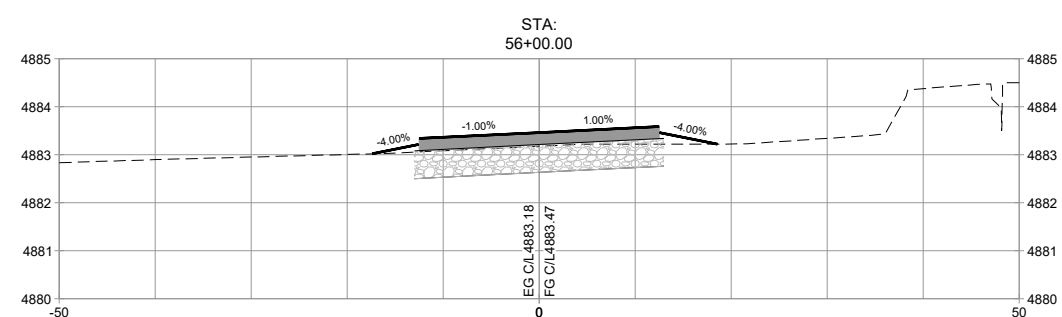
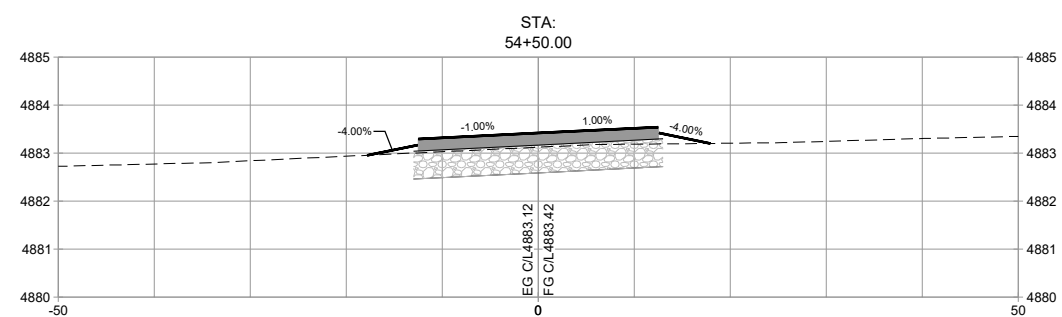
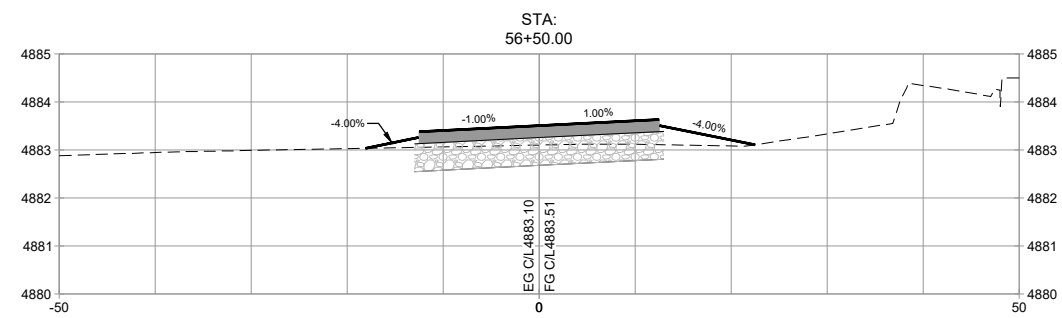
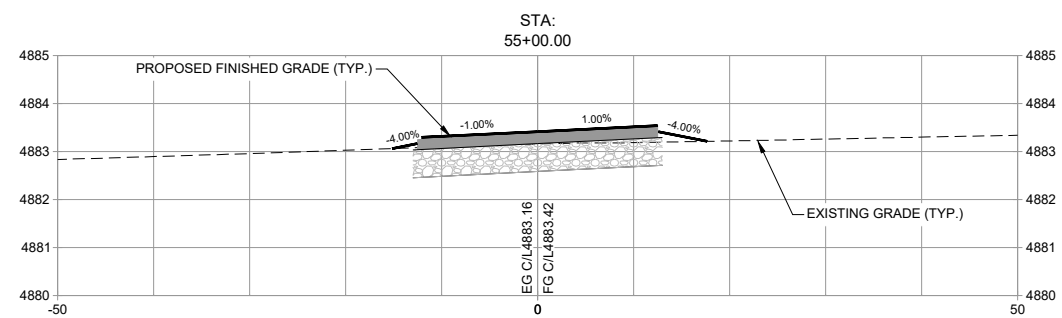
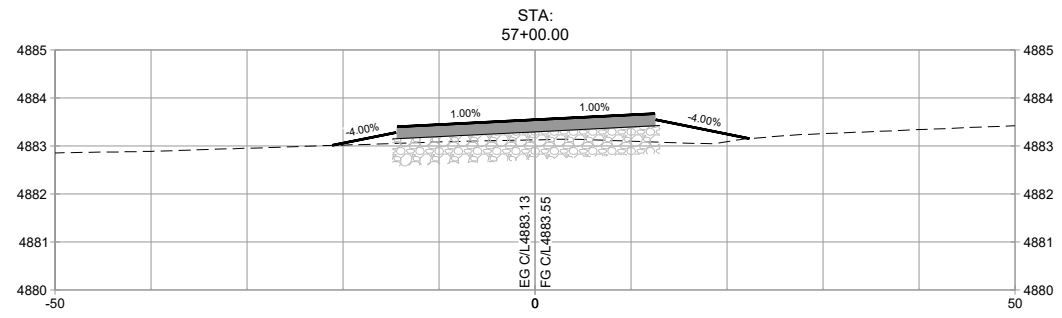
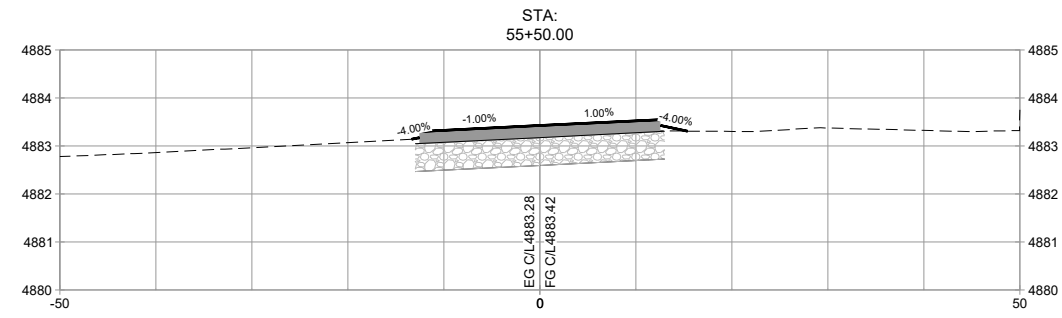

WEST DESERT AIRPORT  
FAIRFIELD, UTAH  
CONSTRUCTION PLANS  
TAXIWAY EXTENSION

No.	Revision	Date	By

ACI No. 206685  
Date: NOV. 2021  
File Name: 206685105

Drawn: MLM  
Checked: JPH  
Approved: DJH

TAXIWAY A  
SECTIONS

S:\Uton\West\_Desert\_Airpark\Project\_Files\Active\_Projects\206685 - West\_Desert - Taxiway\_Extension\CAD\dwg\206685105.dwg 12/17/2021 9:28:17 AM MMONROE

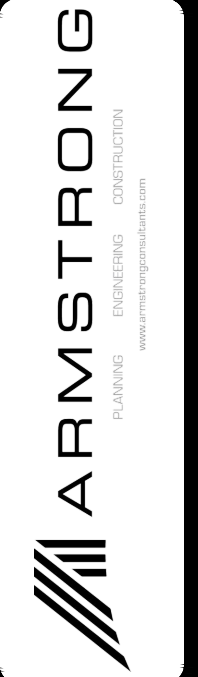
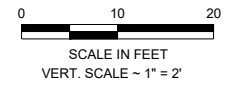
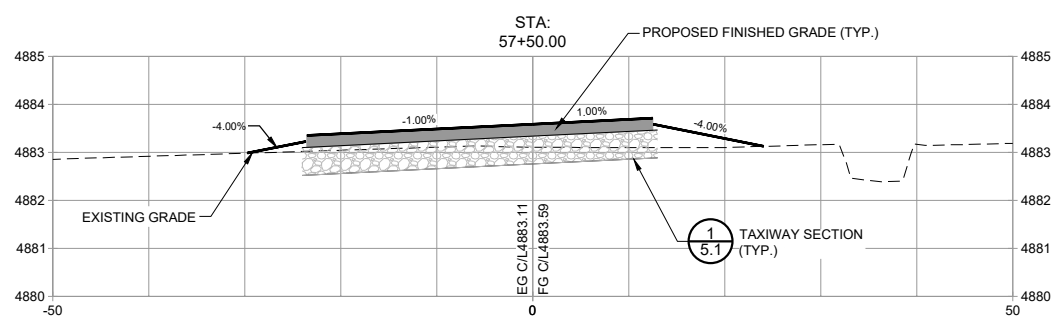

WEST DESERT AIRPORT  
FAIRFIELD, UTAH  
CONSTRUCTION PLANS  
TAXIWAY EXTENSION

No.	Revision	Date	By

ACI No. 206685  
Date: NOV. 2021  
File Name: 206685105

Drawn: MLM  
Checked: JPH  
Approved: DJH

TAXIWAY A  
SECTIONS

Sheet: 8.3

S:\Uton\West\_Desert\_Airpark\Project\_Files\Active\_Projects\206685 - West\_Desert - Taxiway\_Extension\CAD\dwg\206685106.dwg 2/10/2022 1:52:54 PM MMONROE

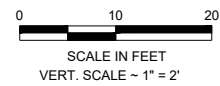
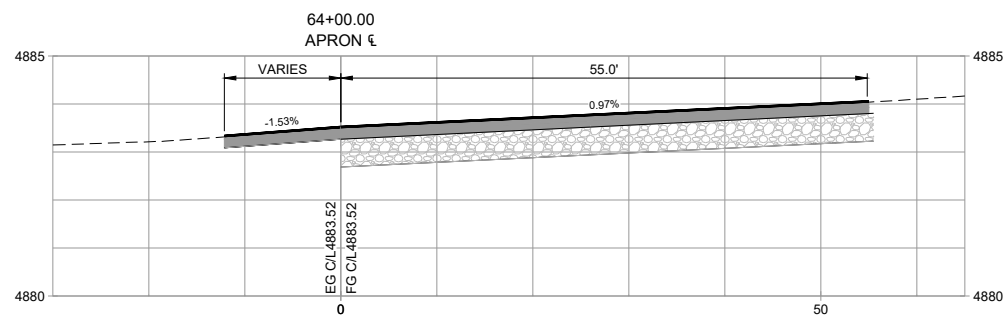
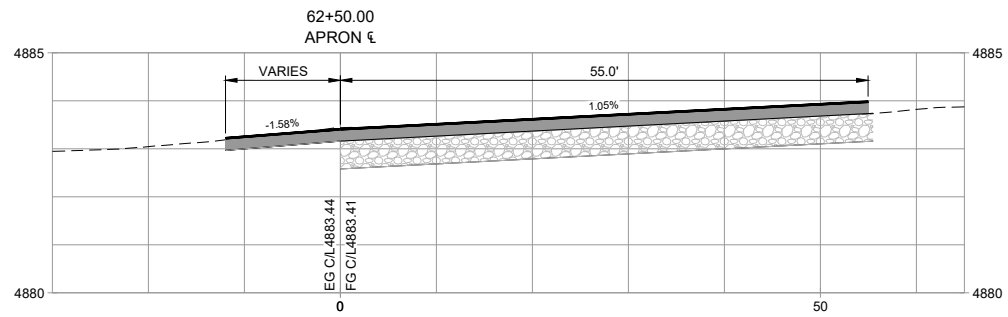
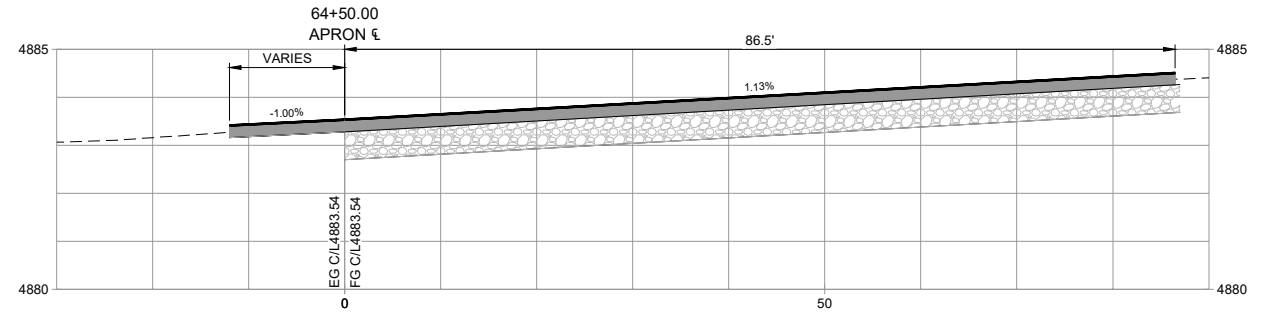
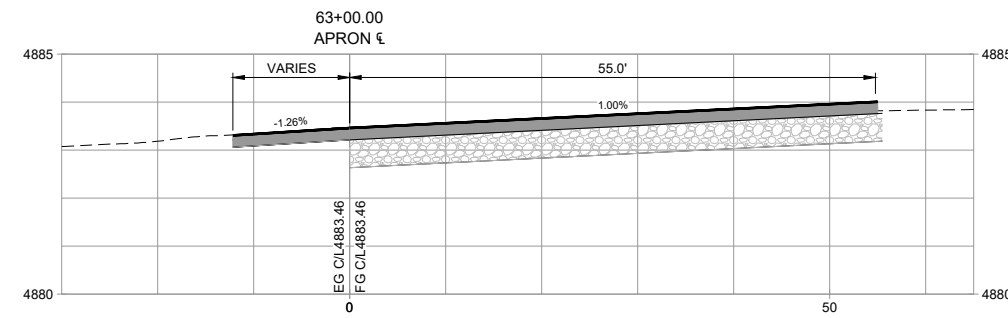
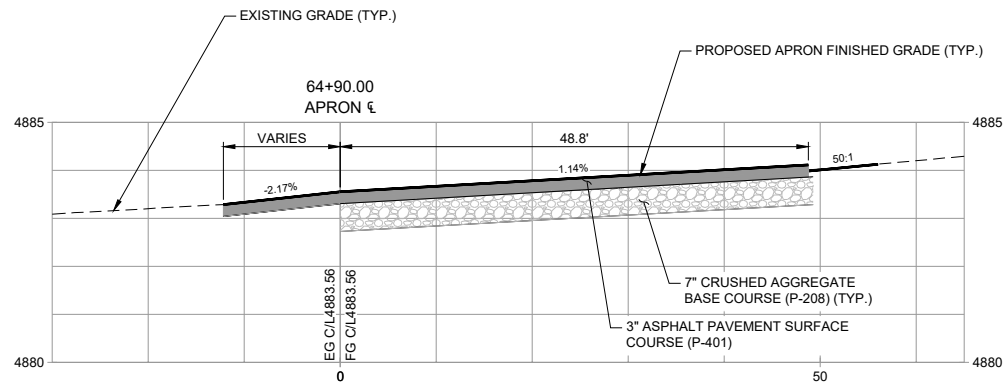
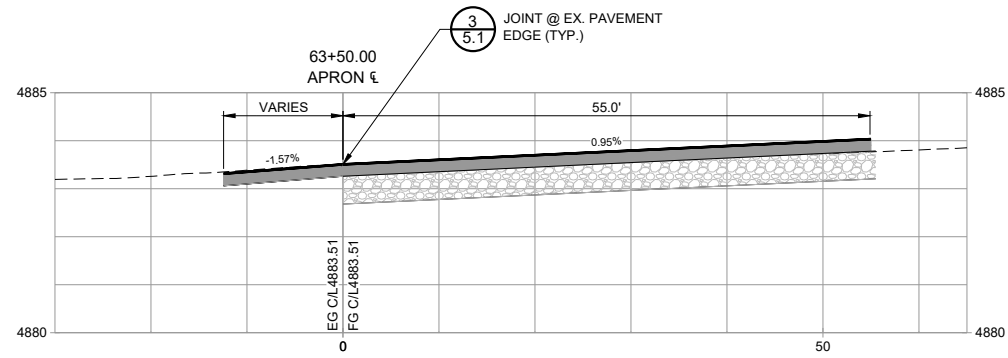

No.	Revision	Date	By

ACI No. 206685  
Date: NOV. 2021  
File Name: 206685106

Drawn: MLM  
Checked: JPH  
Approved: DJH

APRON  
SECTIONS

Sheet: **8.4**

S:\Utah\West Desert Airport\Project Files\Active Projects\206685 - West Desert - Taxiway Extension\CAD\dwg\206685150.dwg 12/20/2021 9:52:49 AM MMONROE

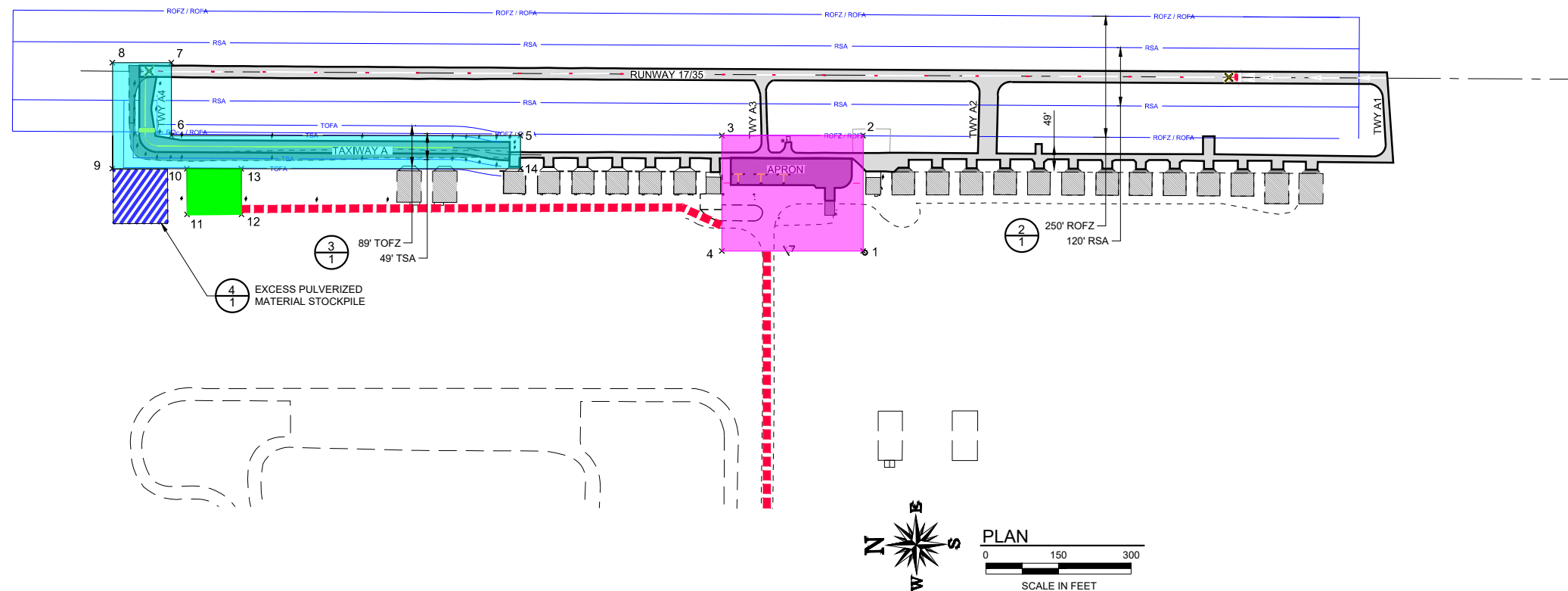

WORK AREA COORDINATES			
POINT #	ELEVATION	LATITUDE	LONGITUDE
1	4885'	N051°11'08.09"	W112°12'38.28"
2	4883'	N051°11'08.11"	W112°12'34.60"
3	4883'	N051°11'10.94"	W112°12'34.64"
4	4885'	N051°11'10.93"	W112°12'38.32"
5	4883'	N051°11'14.98"	W112°12'34.69"
6	4883'	N051°11'21.98"	W112°12'34.79"
7	4882'	N051°11'21.99"	W112°12'32.46"
8	4882'	N051°11'23.18"	W112°12'32.48"
9	4883'	N051°11'23.16"	W112°12'35.86"
10	4883'	N051°11'21.67"	W112°12'35.84"
11	4884'	N051°11'21.65"	W112°12'37.30"
12	4884'	N051°11'20.56"	W112°12'37.28"
13	4883'	N051°11'20.57"	W112°12'35.82"
14	4884'	N051°11'14.98"	W112°12'35.75"

**LEGEND**

- PHASE 1 WORK AREA
- PHASE 2 WORK AREA
- CONTRACTOR STAGING AREA
- LOW PROFILE BARRIER
- CONTRACTOR HAUL ROUTE
- DETAIL #
- SHEET #
- ROFA = RUNWAY OBJECT FREE AREA
- ROFZ = RUNWAY OBSTACLE FREE ZONE
- RSA = RUNWAY SAFETY AREA
- TOFA = TAXIWAY OBJECT FREE AREA
- TSA = TAXIWAY SAFETY AREA

**LATITUDE AND LONGITUDES (LAT/LONG) DELINEATION OF THE CONSTRUCTION AREA AND CONTRACTOR STAGING AREA LIMITS**

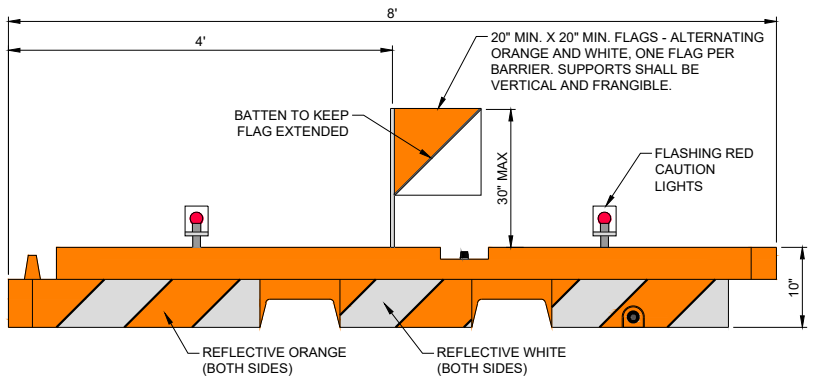

- NOTES:**
- BARRIER SHALL BE SHERWIN INDUSTRIES, 10" x 96" LOW PROFILE AIRPORT BARRIER, AS SHOWN, OR APPROVED EQUAL.
  - THE ENTIRE AREA OF ORANGE AND WHITE STRIPES SHALL BE REFLECTORIZED WITH SMOOTH SURFACE TYPE REFLECTIVE SHEETING.
  - LIGHTS MUST BE MOUNTED ON BARRIERS AND SPACED AT NO MORE THAN 10 FT.
  - THE BARRIERS SHALL BE WEIGHTED AGAINST PROPWASH AND CAPABLE OF WITHSTANDING UP TO 100 M.P.H. WIND FORCES.
  - FLASHING RED CAUTION LIGHTS SHALL BE BATTERY OPERATED AND SHALL MAINTAIN SUCH INTENSITY SO AS TO BE READILY IDENTIFIED FROM DISTANCES OF AT LEAST 200 FEET DURING DARKNESS.
  - THE CONTRACTOR SHALL CHECK ALL BARRIERS AND LIGHTS EACH DAY BEFORE LEAVING THE AIRPORT TO ENSURE LIGHTS ARE WORKING PROPERLY AND MAY NOT LEAVE WITHOUT ALL BARRIERS AND LIGHTS BEING IN PROPER WORKING ORDER.

**1**  
**1** LOW PROFILE SAFETY BARRIER  
NOT TO SCALE

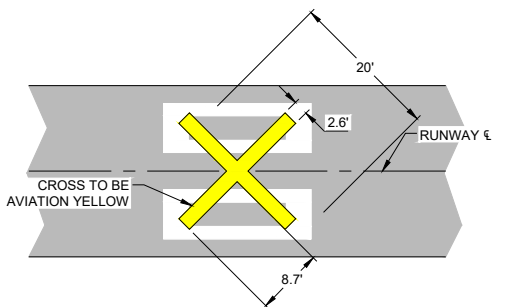

**2**  
**1** RUNWAY CLOSURE CROSS  
NOT TO SCALE

**NOTE:**  
2 EACH REQUIRED PER CLOSED RUNWAY- INCIDENTAL. TO BE APPLIED OVER RUNWAY NUMERALS ON RUNWAY OR AT RUNWAY ENDS PRIOR TO RUNWAY CLOSURE. CROSSES TO BE CONSTRUCTED OF PLYWOOD OR OTHER FLAT MATERIALS WHICH SHALL BE SECURELY FASTENED TO PAVEMENT AND/OR ADEQUATELY WEIGHTED WITH SAND BAGS.

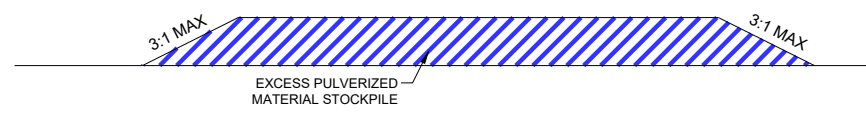

**4**  
**1** STOCKPILE  
NOT TO SCALE

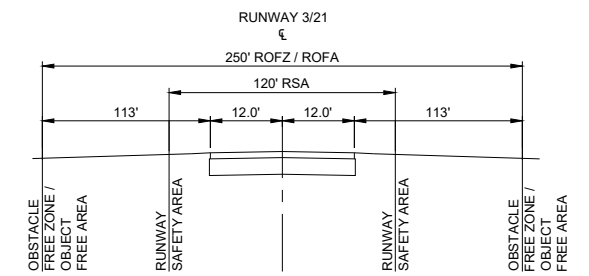

ALL CONSTRUCTION EQUIPMENT, STOCKPILES, AND TRAFFIC MUST REMAIN CLEAR OF ANY OPEN RUNWAY OBSTACLE FREE ZONE / OBJECT FREE AREA.

**3**  
**1** SAFETY AREAS  
NOT TO SCALE

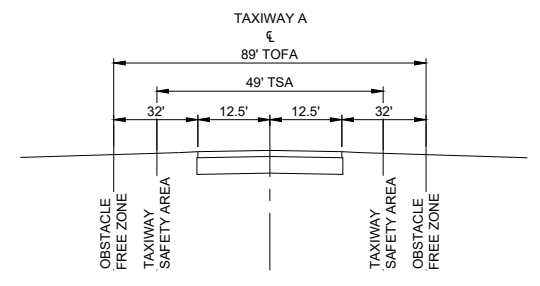

ALL CONSTRUCTION EQUIPMENT, STOCKPILES, AND TRAFFIC MUST REMAIN CLEAR OF ANY OPEN TAXIWAY OBJECT FREE AREA.

**4**  
**1** SAFETY AREAS  
NOT TO SCALE



WEST DESERT AIRPORT  
FAIRFIELD, UTAH  
CONSTRUCTION PLANS  
TAXIWAY EXTENSION

No.	Revision	Date	By

ACI No. 206685  
Date: NOV. 2021  
File Name: 206685150

Drawn: MLM  
Checked: JPH  
Approved: DJH

CONSTRUCTION  
SAFETY &  
PHASING  
PLAN